



**ANSWER COALITION
1st Amendment Demonstration
(24-1278)**



**Incident Brief
Wednesday July 24, 2024**

Jessica Taylor
Chief of Police

Account Number
(b) (7)(E)

| | | | |
|---|---|-------------------------|-------------------------|
| Incident Briefing | 1. Incident Name | 2. Date Prepared | 3. Time Prepared |
| | ANSWER Coalition | 7/22/2024 | 0100 hrs |
| 4. Operational Period (Date and Time) and Participation (number of people) | | | |
| 7/24/2024 | | 0600- Relief | 5,000 |
| 5. Incident Objectives | | | |
| | To safeguard and protect human life | | |
| | To safeguard and protect Park resources, both natural and cultural | | |
| | To maintain law and order throughout NPS areas throughout the duration of this operational period | | |
| | To ensure that any lawful demonstrations, either pro or counter, occur without disruption | | |
| | To safeguard and protect agency personnel | | |
| | To keep costs commensurate with incident needs | | |
| 6. Additional Information for Incident | | | |
| <p>General Overview: On Wednesday 07/24/24 at approximately 1100 hours, ANSWER Coalition will be gathering on Pennsylvania Avenue, John Marshall Park, and the Meade Statue for a First Amendment Demonstration to "stop the genocide in Gaza". The group also intends to protest an address by the PM of Israel to a joint session of Congress. A march will occur after the rally and programming has concluded. USPP will provide site security of National Park Service properties, traffic control, crowd control, tactical response, plain clothes operations, and other law enforcement services as needed.</p> | | | |
| <p>Accounting: <u>All work (regular and overtime) performed in connection with this special event will be charged to account:</u> (b) (7)(E) The following supervisors shall ensure that a 10-344 is completed for all Force personnel assigned to them. All reports shall be completed and submitted to Ofc. (b) (6), (b) (7)(C) at (b) (6), (b) (7)(C)</p> | | | |
| <p>Communications: USPP Admin USPP will have a representative at the MPD JOCC. USPP will have a representative at the USCP JOCC. USPP will have a representative at (b) (7)(E)</p> | | | |
| <p>EOD: (b) (7)(E)</p> | | | |
| <p>Evacuations/Safe Haven: For a weather related incident, USPP personnel working the event will be able to take shelter in government vehicles. All participants of the event will utilize available public access buildings for shelter as it is not provided by the organizer. For a critical incident, event participants will be directed away from the incident to safety. The direction of the evacuation will ultimately be determined by the Incident Commander based on the totality of the circumstances.</p> | | | |
| <p>Logistics: Vehicles will be provided by USPP District 1 as needed for transportation of personnel to and from the site. No meals provided. Supervisors are encouraged to provide breaks for food and water as needed.</p> | | | |
| <p>March Route: 3rd Street NW, East on Constitution Ave NW, North on Louisiana Ave, and terminate in Columbus Plaza.</p> | | | |

Marshals / Security: The organizer will have 200 marshals that will be assigned to permitted areas to maintain order. They will be identified by arm bands and vests.

Media: The organizer will have a media staging area on Constitution Ave NW west of 3rd Street on city property.

Medical: The organizer will have a First Aid tent which will be staffed by a team of health care professionals. They will also have a Hydration tent for water distribution. These will be located in John Marshall Park.

DCFEMS will be staging additional assets in the area of the National Mall in anticipation of increased visitation. DCFEMS will provide 2 Command Supervisors, 4 medic units, and 2 UTV's for patient extraction.

Permit Holders: 24-1278 ANSWER Coalition - (b) (6)

Traffic / Road Closures:USPP will be closing Madison and Jefferson Drive from 3rd to 7th Street in anticipation of increased visitation and a march that will be conducted after the rally has ended. MPD will be enacting road closures on Pennsylvania Ave between 3rd and 6th Street NW. MPD will be providing intermittent road closures to facilitate a First Amendment march.

Notes: The organizer indicated an interest in deploying a banner (with breaks) on MPD roadways to conduct their 1st Amendment Demonstration. The march route may move in a direction which goes around the US Capitol. The organizer has indicated to NPS they are not going to be performing acts of civil disobedience. Organizer indicated 31 buses are transporting people to the rally and parking at Union Station.

(b) (7)(E)

(b) (7)(E)

8. Timeline

0600 hours: MPD reports to road closures

0600 hours: USPP reports to road closures

0600 hours: USPP Special Detail Roll Call

1000 hours: Pre-rally begins

1100 hours: ANSWER Rally begins

1300 hours: March departs rally site

1600 hours: March ends

TBD hours: USPP Detail concludes

| | | |
|--|---|---|
| 8. Intelligence Report | | |
| <p>((U//FOUO) On 24 July 2024, various groups will meet in the vicinity of the U.S. Capitol to demonstrate against Israeli Prime Minister Benjamin Netanyahu as he addresses a Joint Session of Congress. Large crowds possibly reaching up to 15,000 people are expected. While this total attendance figure will be realized through multiple smaller groups, the main focus of the day's events will be centered upon the ANSWER Coalition and their permitted event planned to take place at Pennsylvania Ave. and 3rd Streets, NW. Exact plans for the event are still being finalized with event planners, but the rough run of show entails speakers from the stage area followed by a possible musical performance and then a march with an as of yet undetermined route and destination.</p> <p>(b) (7)(E)</p> <p>(b) (7)(E)</p> <p>.</p> | | |
| 9. Attachments | | 10. Personnel Assigned |
| See Maps | | Special Detail |
| ICS-202A-PP | 11. Prepared by (PSC) Lieutenant Timothy Van Dyke | 12. Approved by (PSC) Major Frank Hilsher |

ANSWER Coalition

Map Key

- Closure Area
- USPP Vehicle
- REACT 0600
- REACT 1200
- CDU

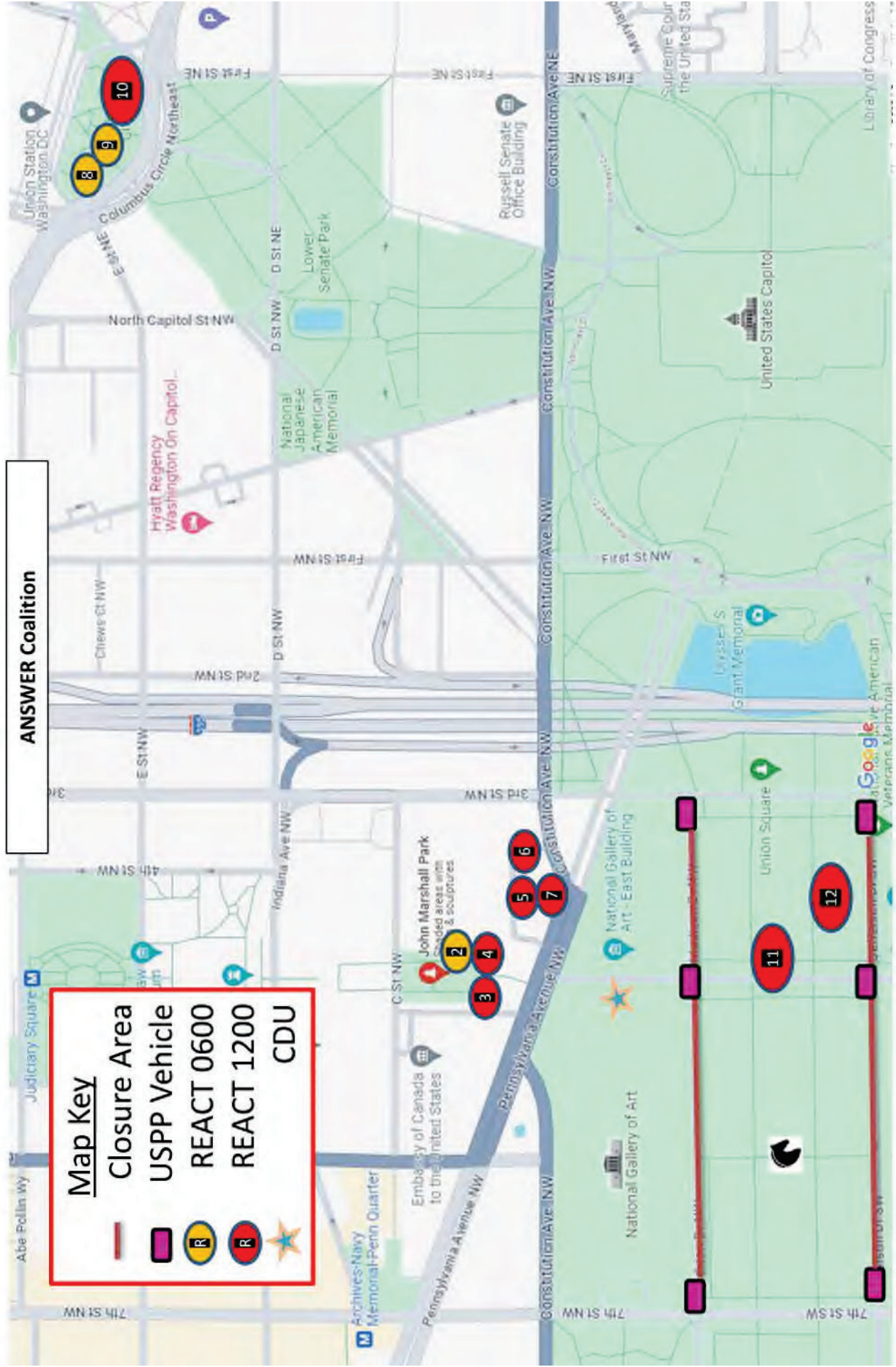

**First Amendment Activity
7/24/24**

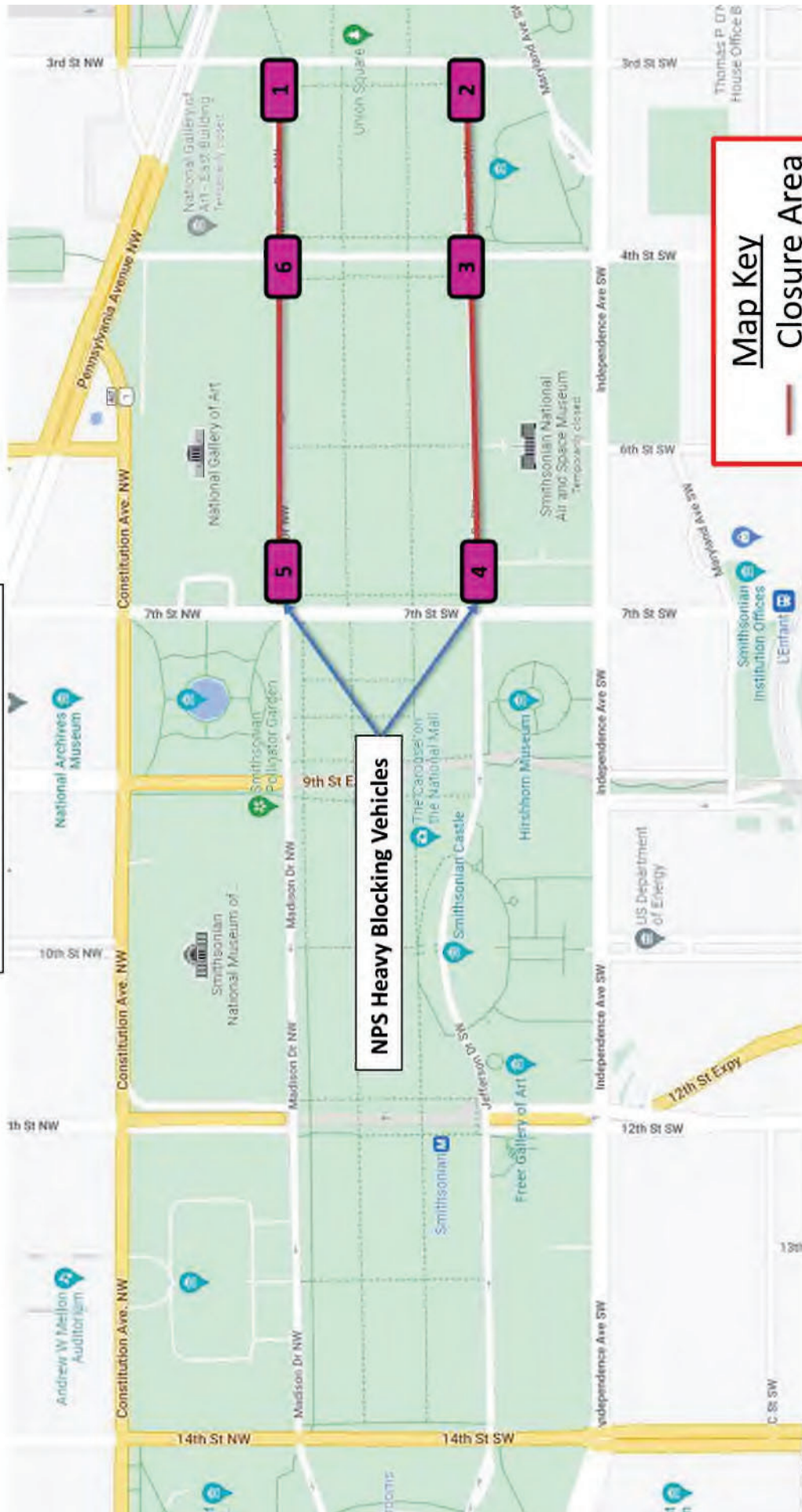

NPS Heavy Blocking Vehicles

Map Key

- Closure Area
- USPP Vehicle

ANSWER Coalition
March Route 7/24/24

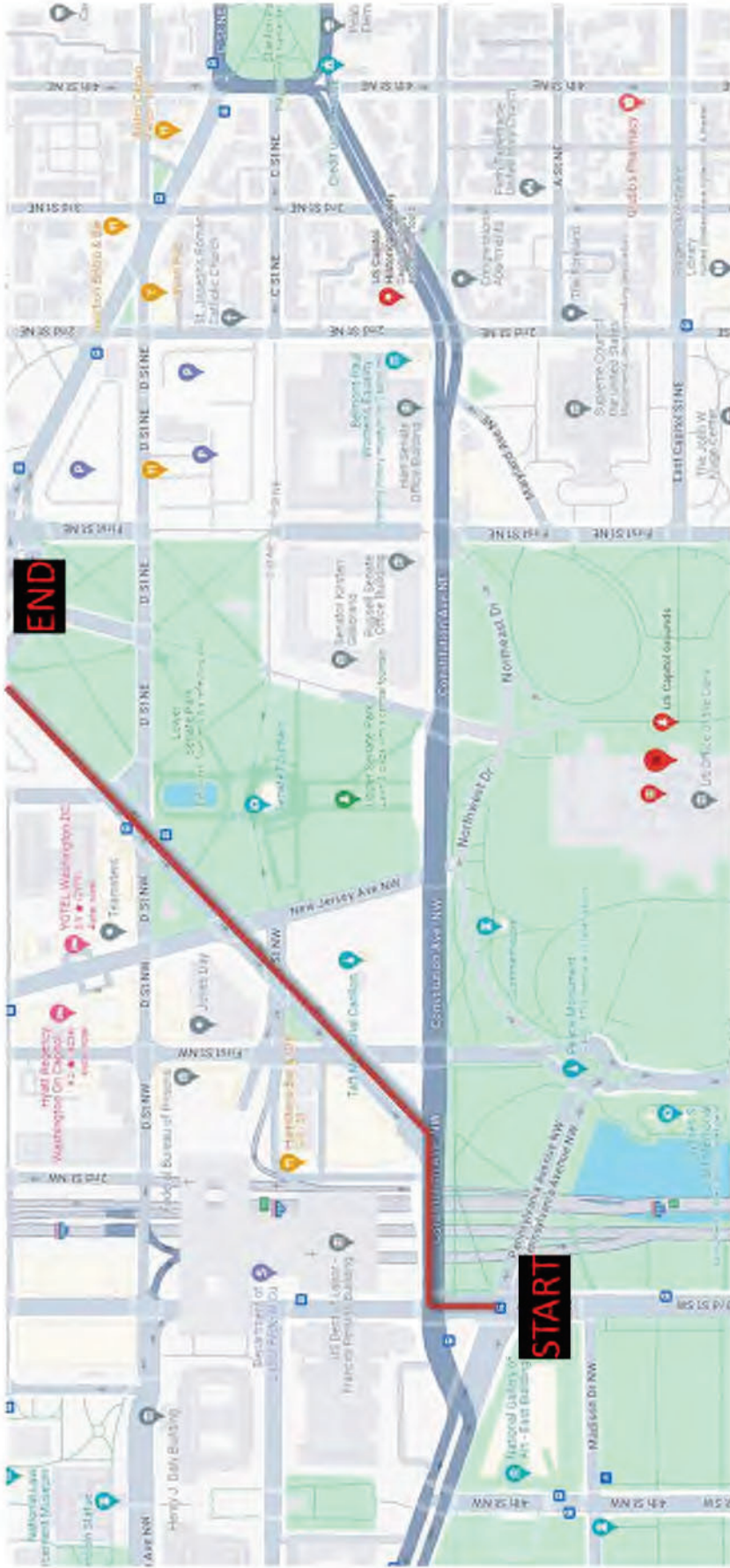



IN REPLY REFER TO:

United States Department of the Interior

NATIONAL PARK SERVICE
National Capital Region
1100 Ohio Drive, S.W.
Washington, D.C. 20242

PUBLIC GATHERING PERMIT

Permit: NCA-NAMA-EVNT24-1278

Date: July 23, 2024

In accordance with Park Regulations as contained in C.F.R., Title 36, Chapter 1, Section 7.96, permission is granted to conduct a public gathering to the following:

Person(s) and/or Organization(s): ANSWER Coalition

Dates & Time(s): 7/24/2024 5:00 AM

To: 7/24/2024 4:00 PM

Location(s):

Columbus Plaza; John Marshall Park; Pennsylvania Avenue North Sidewalk, 3rd - 5th Street
Pennsylvania Avenue South Sidewalk, 3rd - 5th Street

Purpose: Stop the genocide in Gaza

Anticipated Number or Participants: 5000

Person(s) in Charge: (b) (6)

Address(es): (b) (6)

Phone Number: (b) (6)

Mobile Number:

On-Site Contact: (b) (6)

Mobile Number: (b) (6)

On-Site Contact: (b) (6)

Mobile Number: (b) (6)

On-Site Contact: (b) (6)

Mobile Number: (b) (6)

*Organizer refused to provide specific locations for onsite contacts.

This permit is granted subject to the following conditions:

1. Permittee and all participants authorized therein must comply with all of the conditions of this permit and with all reasonable directions of the United States Park Police.
2. All sidewalks, walkways, and roadways must remain unobstructed to allow for the reasonable use of these areas by pedestrians, vehicles and other park visitors.

PERMITTEE IS RESPONSIBLE FOR READING AND ADHERING TO ATTACHED
ADDITIONAL CONDITIONS.

PERMIT: #24-1278

ISSUED TO: ANSWER COALITION

LOCATION: JOHN MARSHALL PARK, PENNSYLVANIA AVENUE NHS, NORTH AND SOUTH
SIDEWALKS, AND COLUMBUS PLAZA

DATE: JULY 24, 2024 (5:00 AM –4:00 PM)

Activity Overview:

The ANSWER Coalition will conduct a demonstration to stop the genocide in Gaza. The demonstration will occur from 10:00 am – 1:00 pm feature speeches and conclude with a march to Columbus Plaza. The primary location for the demonstration is on the closed portion of Pennsylvania Avenue between 3rd-5th Streets. There will be portable restrooms, hydration station, button sales area and a first aid stand setup in John Marshal Park. The Pennsylvania Avenue sidewalks between 3rd-5th Street will be used as overflow area for participants. The maximum estimated number of participants is 5000.

Timeline Overview**Pennsylvania Avenue -3rd -4th Street (MPD Jurisdiction)**

| | |
|---------------------|--|
| 5:00 am | Setup of Stage and delay towers |
| 6:00 am - 12:00 pm | Staggered bus drops on C Street between 4 th -6 th |
| 10:00 am – 11:00 am | Pre-rally music and speeches |
| 11:00 am – 1:00 pm | Demonstration |
| 1:00 pm 1:15 pm | March to Columbus Plaza |

John Marshal Park and Pennsylvania Avenue between 3rd -5th Streets

| | |
|--------------------|---|
| 5:00 am | Delivery of portable restrooms and setup of tents |
| 6:00 am - 11:00 am | Buses arrive. |
| 6:00 am – 2:00 pm | Portable Restrooms, First Aid and Hydration Stations open |
| 1:15 pm – 3:00 pm | Clean up and removal of equipment |
| 4:00 pm – 7:00 pm | Buses pickup on C Street |

Columbus Plaza

| | |
|-------------------|---------------------------------|
| 2:00 pm – 2:15 pm | March arrives in Columbus Plaza |
| 2:15 pm – 3:45 pm | Rally: chant, hold signs. |
| 3:45 pm – 4:00 pm | Participants begin to disperse. |

John Marshall Park -authorized equipment.

3 - 10x10ft Canopy Tents

VOLUNTEER TENT:

Table x3

Chairs x10

WATER TENT:

Table x3

Chairs x10

Water

FIRST AID TENT:

Table x3

Chairs x10

Pennsylvania Avenue sidewalks (north and south)

Table

Buttons

PERMIT: #24-1278

ISSUED TO: ANSWER COALITION

LOCATION: JOHN MARSHALL PARK, PENNSYLVANIA AVENUE NHS, NORTH AND SOUTH SIDEWALKS, AND COLUMBUS PLAZA

DATE: JULY 24, 2024 (5:00 AM –4:00 PM)

Columbus Plaza

Handheld signs

Portable sound system

March route

Exit Pennsylvania Avenue and 3rd Street

East on Constitution Avenue cross 3rd Street

Northeast onto Louisiana Avenue

East on Massachusetts Avenue

Enter Columbus Plaza

General Conditions

- A. This permit authorizes the use of the following park areas located within National Mall and Memorial Parks from 5:00 am on July 24 and concluding at 4:00 pm on July 24, 2024:
 - a. John Marshall Park
 - b. Pennsylvania Avenue NHS north and south sidewalks between 3rd – 5th Streets
 - c. Columbia Plaza (2:00 pm -4:00 pm)
- B. All structures must adhere to attached site plan; no additional structure (s) may be erected except in accordance with the site plan, permit and in coordination with permits office. Permittee indicated they are no longer setting up symbolic tents as part of the demonstration. Structures not listed in the permit will be removed and all permitted structures must be erected by the start of the demonstration rally start time. See equipment list above. **No site plan was provided by organizer as required by event guidelines.**
- C. ***NOTE: Due to the possibility of security measures, Presidential movements, and Head of State visits, permitted activity locations may be, temporarily moved and/or suspended.**
- D. The permittee is responsible for adhering to NCA Fire and Life Safety Temporary Event Policy and ensuring that all generators, tents, portable heaters and other applicable equipment adhere to requirements outlined with the document and this permit. The permittee assumes full responsibility for event elements safety and must ensure their contractors fully understand requirements outlined in the permit. In addition, the site must be ready for inspection by AHJ and/or designated representative prior to the event and upon request.
- E. The Permittee is responsible for obtaining the necessary permissions and/or additional permits from the Metropolitan Police Department (202) 671-6522, United States Capitol Police (202) 224-8891 or from other federal, state or local agencies or departments for the use of public lands other than those under the jurisdiction of the National Park Service.
- F. **Due to the exceptional time constraints associated with this permit and the complexity of multiple vendors bringing materials and equipment to park land, special attention is assigned to the requirement that the permittee must at all times provide an on-site coordinator at each permitted location to be accessible to National Park Service and United States Park Police personnel during the setup activities and during the load in/out of the event.**

PERMIT: #24-1278

ISSUED TO: ANSWER COALITION

LOCATION: JOHN MARSHALL PARK, PENNSYLVANIA AVENUE NHS, NORTH AND SOUTH SIDEWALKS, AND COLUMBUS PLAZA

DATE: JULY 24, 2024 (5:00 AM –4:00 PM)

- G. If Permittee or its agents/representatives/contractors/subcontractors cause any injury or damage to park system resources, they may be liable for costs and damages in accordance with the System Unit Resource Protection Act, 54 USC §§ 100721-100725.**
- H. Permittee will be responsible for any injury to, loss of, or damage to federally owned or controlled lands, waters, or resources (natural or cultural resources or facilities) resulting from Permittee's activities under this permit, 18 USC § 1361.**
- I. All request, correspondence and meetings with the National Park Service pertaining to this permit shall be scheduled by the permittee in writing only. All contractors, subcontractors or consultants must channel their request through the recognized representatives of the permittee who in turn will contact the National Park Service representative.
- J. The Permittee is responsible for providing all necessary equipment/objects to conduct this activity. All equipment must be removed from the park immediately following the conclusion of the event. Items left in the park will be considered abandoned property and will be removed by the National Park Service.
- K. Throughout the course of the permit, the Permittee will require employees/volunteers, and contractors, to exercise special care and attention to protect the resources of the permitted area and its environs. In addition, the Permittee must supervise their contractors, volunteers, and employees during setup and teardown to assure that there is no damage to park resources. The onsite contacts for ANSWER are:
 - 1. John Marshal Park:
 - 2. Columbus Plaza:
 - 3. Pennsylvania Avenue North Sidewalk b/w 3rd-5th Strs.:
 - 4. Pennsylvania Avenue South Sidewalk b/w 3rd-5th Strs.:

The contacts must be present physically present at each of the location for the entire duration demonstration permit times. (See above timelines)

- L. The permittee shall require all employees and/or contractors to exercise all normal and reasonable safety precautions and to protect park visitors and property. Suitable devices such as barricades, fences, lanterns, etc. necessary for employee and public safety, shall be provided and adequately maintained. Such devices require the concurrence of the NPS Coordinator or designated representative.
- M. **Marshals:** The ANSWER Coalition will provide at least 200 identifiable marshals to coordinate the various areas of the demonstration. All marshals involved with the organization will wear hi-res security vest and/or armbands. Pursuant to 36 CFR 7.96 (g)(5)(xii) organizers must undertake in good faith all reasonable action to provide sufficient marshals, to ensure good order and self-discipline in conducting such demonstration. Marshals should be aware of their responsibilities and location(s) where they will be stationed and have received from organizers adequate training and instructions. Marshals should be aware of the time and location of the assembly and any march routes, the location of any first aid stations, water, and toilets, be knowledgeable of the NPS permit conditions, be able to communicate with law enforcement. Marshals' area expected to report any problems they observe to Law Enforcement and/or National Park Service Permit Monitors. While marshals do not act as police, they do help maintain order among participants, explain to non-participants that a particular area may be under permit, and be able to alert their supervisor and the United States Park Police in the event they observe a problem on Federal parkland.

PERMIT: #24-1278

ISSUED TO: ANSWER COALITION

LOCATION: JOHN MARSHALL PARK, PENNSYLVANIA AVENUE NHS, NORTH AND SOUTH SIDEWALKS, AND COLUMBUS PLAZA

DATE: JULY 24, 2024 (5:00 AM –4:00 PM)

N. No interference with the pedestrian traffic and no blocking of entrances, sidewalks, or driveways is allowed. No impediment to or disruption of vehicular traffic is permitted. All areas are to remain open to the general public at all times.

O. Medical Aid: Person in charge is responsible for providing first aid services onsite. Permittee is required to adhere to recommendations provided by DC Fire and EMS. Permittee can rely on 911 for transport of patient. At a minimum permittee must have one Basic Life Support Medical Aid station and mobile med teams in all permitted locations. Please see attached plan for permittee medical plan.

1. John Marshall Park

Permittee per written first aid plan: Hydration Station(1) and First Aid Station (1) staffed by doctors, nurses and health care professionals from 10 am - ~1:00 pm.

P. Commercial Advertising Signage: Consistent with long-standing NPS regulations and policy, and Public Law 108-108, Title I, §145, the erection, placement, or use of structures and signs bearing commercial advertising is prohibited for any special event. The recognition of special events sponsors, however, may be allowed if it has been specifically authorized by this permit.

A permit may be issued that authorizes the recognition of sponsors of special events, if the NPS determines that the size and form of the recognition is consistent with the special nature and sanctity of the National Mall or any other requested park area, and if the lettering or design identifying the sponsor is no larger than one-third the size of the lettering or design identifying the special event. Further, to the maximum extent practicable for such special events, public use of and, access to the National Mall and other parkland is not to be restricted.

The Permittee shall submit a sign plan for NPS review and approval. Any request seeking NPS approval for sponsor recognition must be submitted to the NPS at least 14 days prior to the proposed event, and if approved by the NPS, will be authorized within the terms of the special event permit. Authorized sponsor recognition must be in keeping with NPS policy, regulations, and laws and be appropriate to the scale and theme of the special event. Further, the overall size, number, and design of any signs or banners shall be appropriate to the park setting and lettering or design identifying the special event. Signs and banners may not be affixed to existing trees or other NPS facilities or structures.

Only signs and/or banners specifically identifying and/or announcing the event or portion of the event are permitted. Commercial sponsors may be recognized on these same banners by letters and/or logos not to exceed one-third the height and width of the primary lettering identifying the event.

Q. Special attention is drawn to item #4, on the last page of this document, concerning solicitation and sales. No fee may be collected, donation solicited, or commercial activity conducted. No items may be sold or offered for sale except for books, newspapers, leaflets, pamphlets, buttons and bumper stickers which contain a message related to your demonstration or special event. Permittee will have onsite sales at John Marshall Park, Pennsylvania Avenue Sidewalks north and south between 3rd-4th Streets, the stand or structure may consist of one table per site, which may be no larger than 2 ½ ft by 8ft or 4ft by 4ft. The dimensions of the sales site may not exceed 6ft (w) by 15ft long by 6ft high. No other items maybe sold other than those listed.

Sales table is located in the John Marshall Park and Pennsylvania Avenue Sidewalks between 3rd – 5th Streets, permittee has not provided a detailed site plan. Permittee has indicated the sales of buttons.

PERMIT: #24-1278

ISSUED TO: ANSWER COALITION

LOCATION: JOHN MARSHALL PARK, PENNSYLVANIA AVENUE NHS, NORTH AND SOUTH
SIDEWALKS, AND COLUMBUS PLAZA

DATE: JULY 24, 2024 (5:00 AM –4:00 PM)

- R. **All sound amplification equipment shall be limited so that it will not unreasonably disturb nonparticipating persons in, or in the vicinity of, the area. National Park Service has issued a Record of Determination in John Marshall Park during regular business hours, therefore no amplified sound is allowed in John Marshall Park as part of this activity.**
- S. **Balloons of any kind, glass containers and alcoholic beverages are not permitted.**
- T. **The collection of entry/registration fee is prohibited on parkland.**
- U. Permittee's desiring the use of temporary structures, i.e. cable trusses, stages, audio and/or video towers and tents, whose dimensions are (500) square feet or more, shall provide Life Safety Code certification statements confirming the safety of all temporary structures. In the event that the manufacture's certifications are not available, permittee will submit to the NPS stamped engineered drawings for NPS review and approval. **Smaller structures cannot be attached or within 5ft of another to create a larger structure.**
- V. All activities pursuant to this permit shall be in compliance with the requirements of Title VI of the Civil Rights Act of 1964 (78 Stat. 252; 42 U.S.C. 200d ed seg.); Title V, Section 504 of the Rehabilitation Act of 1973 (87 Stat. 394; 29 U.S.C 794); the Age Discrimination Act of 1975 (89 Stat. 728; 42 U.S.C. 6101 et seg.); and with all other Federal laws and regulations prohibiting discrimination of grounds of race, color, national origin, handicap, religion, or sex in employment and in providing facilities and services to the public. Nothing advertising for employees shall be done which will prevent those covered by these laws from qualifying for employment.
- W. **Portable Restrooms:** If attendance is expected to exceed the capacity of nearby NPS public comfort facilities, or if none exist in or near the requested park area, the Permittee must provide portable, temporary toilets with sufficient capacity to accommodate anticipated attendance. The general guideline is a minimum of (1) portable toilet per (300) people, of which at least twenty percent (%20) must be handicapped accessible. The restrooms should be grouped in banks of five with a six-foot clearance between each bank.
1. John Marshall Park– 10 Portable Restrooms –The portable restrooms must be hand carted and retrieved for the area.
 2. Portable restroom trucks may not drive on sidewalk and should furnish a hose long enough to clean portable restrooms
 3. Portable restrooms must be delivered and removed the same day of the demonstration.
- X. **Tents:** Permittee's authorized use of temporary structures, i.e. cable trusses, stages, audio and/or video towers and tents, whose dimensions are (900) square feet or more, **shall provide Life Safety Code certification statements confirming the safety of all temporary structures. In the event that the manufacture's certifications are not available, permittee will submit to the NPS stamped engineered drawings for NPS review and approval. Smaller structures cannot be attached or within 5ft of another to create a larger structure.**
- a. **A minimum 10ft. clearance must be maintained from tents to any flammable or combustible materials or vegetation.**

PERMIT: #24-1278

ISSUED TO: ANSWER COALITION

LOCATION: JOHN MARSHALL PARK, PENNSYLVANIA AVENUE NHS, NORTH AND SOUTH SIDEWALKS, AND COLUMBUS PLAZA

DATE: JULY 24, 2024 (5:00 AM –4:00 PM)

- b. Aisle Width:** The width of aisles serving seating at tables shall be not less than 44 in. where serving occupant load exceeding 50 people, and 36 in. where serving an occupant load of 49 people or fewer. In addition all tent exits must have a minimum head clearance height of 7ft.

- c. Exit and Occupant Loads for Enclosed Tents:** Tents that have sides attached and those with rolled up sides which are capable of being enclosed shall meet the following occupancy load and exit requirements.

| Y. Occupant Load Number | Z. Floor Area | AA. Approx. Tent Sizes | BB. Min. Exits |
|-------------------------|-------------------------|-----------------------------------|----------------|
| CC. <49 people | DD. <343 Sq. Ft. | EE. 10'x10', 10'x30', 15'x15' | FF. 1 |
| GG. 50-499 people | HH. 350-3,493 Sq. Ft. | II. 15'x 30', 40' x 40', 40' x80' | JJ. 2 |
| KK. 500-999 people | LL. 3,500-6,993 Sq. Ft. | MM. 40' x 100', 60' x 100' | NN. 3 |
| OO. >1000 people | PP. >7,000 Sq. Ft. | QQ. 80' x 100', 60'x 160' | RR. 4 or more |

SS. Tents must be supported by water barrels or cement blocks. STAKING IS NOT PERMITTED. In order to prevent damage to brick, stonework, or other surfaces, protective material such as plywood, carpet squares or rubber pads must be in place under all equipment, including speaker stands, lighting stands, generators, tables and tents.

TT. GENERATORS: No generators have been requested at the permitted areas, therefore generators are prohibited.

UU. Contact Park Ranger (b) (6), (b) (7)(C), National Park Service, at (b) (6), (b) (7)(C) with questions or to discuss additional information regarding logistical setup.

VV. Contact Lt. Timothy Van Dyke , United States Park Police, (b) (6), (b) (7)(C) with questions concerning police procedures or logistics.

WW. NPS and USPP onsite representatives

- (b) (6), (b) (7)(C) (b) (6), (b) (7)(C)
- (b) (6), (b) (7)(C) (b) (6), (b) (7)(C)
- Tim Van Dyke (b) (6), (b) (7)(C)

XX. In case of an emergency, please contact USPP dispatch at (202) 610-7500.

A complete and legible copy of this permit must be retained on-site by the Permittee at all times while operating under the authority granted.

PERMIT: #24-1278

ISSUED TO: ANSWER COALITION

**LOCATION: JOHN MARSHALL PARK, PENNSYLVANIA AVENUE NHS, NORTH AND SOUTH
SIDEWALKS, AND COLUMBUS PLAZA**

DATE: JULY 24, 2024 (5:00 AM –4:00 PM)

General Resource Protection:

YY. Pursuant to 36 CFR 7.96(g)(xii), the alteration, damage, or removal of park resources or facilities is prohibited. No holes may be dug and no item, including signs or banners, may be attached to park trees, plantings, benches, fences, light standards, or any other park landscape element.

ZZ. It is prohibited to climb, remove, or in any way injure any statue seat, wall, fountain, light poles, elevator towers, or other erection or architectural feature, or any tree, shrub, or landscaping feature within the park. Permittee is responsible for informing event participants and providing marshals to ensure compliance with this permit condition.

AAA. **Public Access:** Sidewalks and entrances seven feet wide or larger, a six foot minimum clearance must be maintained at all times to allow for two wheelchairs to pass each other. And for sidewalks and entrances of (5-6) feet wide, a four-foot minimum width must be maintained at all times for wheel chair accessibility.

BBB. **In order to prevent damage to brick, stonework, or other surfaces, protective material such as plywood or rubber pads must be in place under all equipment, including speaker stands, lighting stands, generators, tables and tents.**

CCC. Helium inflated items and drones are not permitted on Parkland.

DDD. **Trash/debris pickup:** Permittee indicated to be responsible for all trash and debris from the permitted areas immediately after the conclusion of the demonstration. Trash receptacles for this effort shall be provided and removed from the site accordingly by the permit holder. Trash receptacles must not overflow with trash or debris. Use of clear trash bags is required for all trash receptacles used for the event.

EEE. **Fire Hydrants:** A minimum 36 in. of clear space shall be maintained to permit access to and operation of fire protection equipment, fire department inlet connections, or fire protection system control valves. Vehicles must maintain a 15 ft. clearance of all fire hydrants.

FFF. **Outdoor Equipment. (A) Wet Locations.** All switches, circuit breakers, receptacles, control equipment, and metering devices located in wet locations shall be weatherproof.
(NFPA70:551.78 (2017))

GGG. **OPEN-FLAME DEVICES.** Open-flame decorative devices, **candles, oil lamps, decorative torches and gas lights** are **NOT authorized** in any tent or temporary structures.

HHH. **COMBUSTIBLE OR FLAMMABLE LIQUIDS shall NOT be stored on NPS property.**
NCA-AHJ

III. **Weather (adverse) Policy during an Event Program:** When there is a threat to public health or safety, the Superintendent and/or designee, may close the National Mall or an event being hold there for such duration as determined necessary to ensure the safety and well being of the public. Such situations have occasionally occurred in the past where park areas have been closed due to severe weather warning of heavy snow, thunderstorms with lightning, high winds, cold and intense heat. Where an area is ordered closed due to a weather-related public safety threat, pursuant to 36 CFR

PERMIT: #24-1278

ISSUED TO: ANSWER COALITION

LOCATION: JOHN MARSHALL PARK, PENNSYLVANIA AVENUE NHS, NORTH AND SOUTH
SIDEWALKS, AND COLUMBUS PLAZA

DATE: JULY 24, 2024 (5:00 AM –4:00 PM)

2.32 people must comply with official directions to leave the closed area and relocate to safer sheltered locations. Weather will be monitored throughout the duration of the event. Permittee is responsible for ensuring that adequate resources are available to deal with extreme weather conditions. For example extreme heat, cold, snow etc. Permittee is responsible for removing snow from flooring, however the Park Superintendent must approve type equipment used or any deicer.

PERMIT: #24-1278

ISSUED TO: ANSWER COALITION

LOCATION: JOHN MARSHALL PARK, PENNSYLVANIA AVENUE NHS, NORTH AND SOUTH
SIDEWALKS, AND COLUMBUS PLAZA

DATE: JULY 24, 2024 (5:00 AM –4:00 PM)

3. All laws, rules and regulations applicable to the area covered by this permit remain in effect.
4. No fee may be collected, donation solicited, or commercial activity conducted. No items may be sold or offered for sale except for books, newspapers, leaflets, pamphlets, buttons and bumper stickers which contain a message related to your demonstration or special event. No other merchandise may be sold or offered for sale. **A stand or structure used for the sale of permitted items may not exceed one table per site, which may be no larger than 2 1/2 feet by 8 feet or 4 feet by 4 feet. The dimensions of the sales site may not exceed 6 feet wide by 15 feet long by 6 feet high.**
5. The area should be left in substantially the same condition as it was prior to the activities authorized herein, and all litter shall be placed in the trash containers provided.
6. This permit is applicable only for the use of the area designated above, and during the times designated above, or in any area as may hereafter be designated by the United States Park Police.
7. All sound amplification equipment shall be limited so that it will not unreasonably disturb nonparticipating persons in, or in the vicinity of, the area.
8. The National Park Service reserves the right to immediately revoke this permit at any time should it reasonably appear that the public gathering presents a clear and present danger to the public safety, good order or health, or if any conditions of this permit are violated.

(b) (6), (b) (7)(C)

Regional Director

National Capital Region

(b) (6), (b) (7)(C)

Chief, Division of Permits Management

National Mall and Memorial Parks

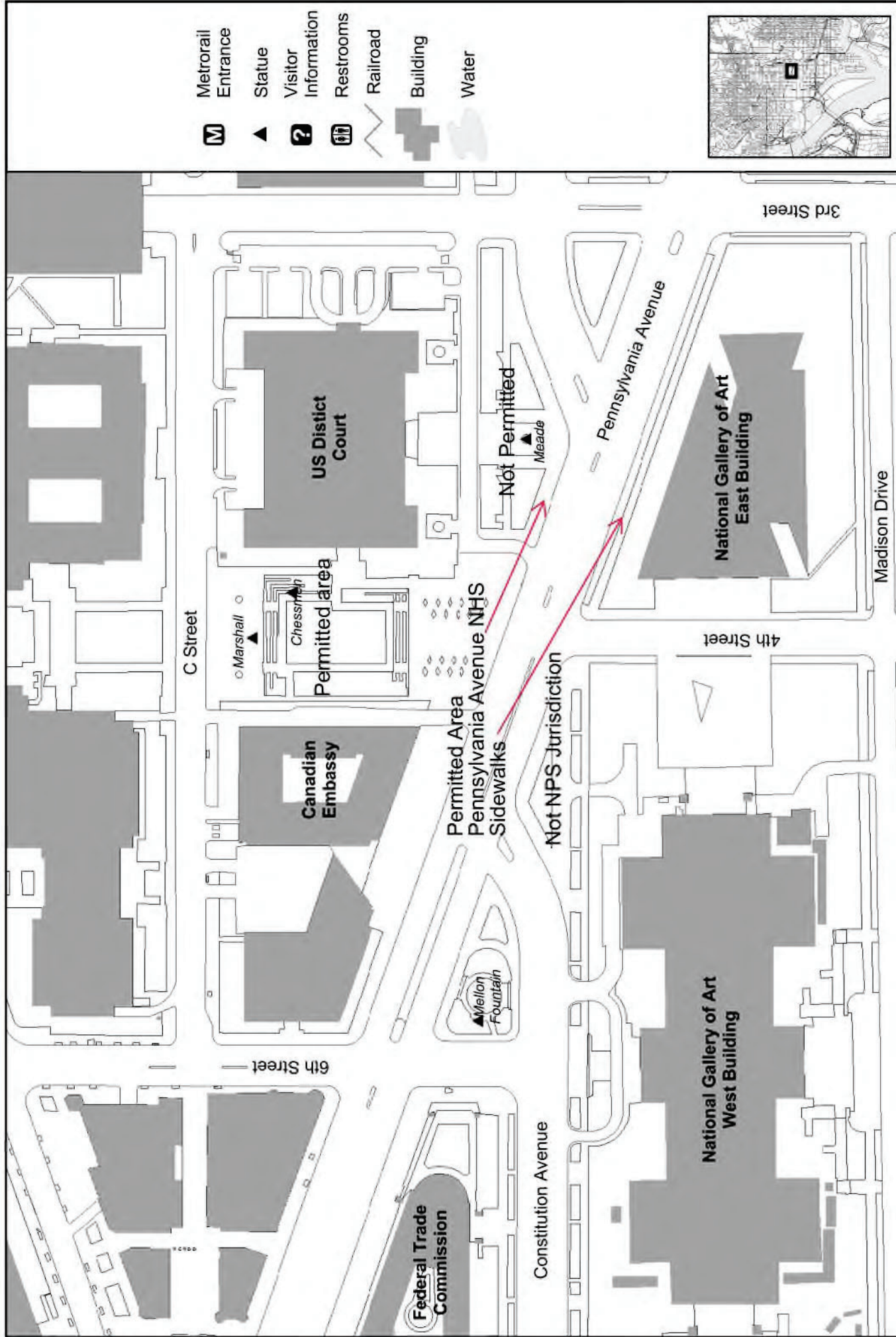



North



100 0 100 200 300



Feet

50 0 50 100



Meters

PENNSYLVANIA AVENUE
NATIONAL HISTORIC PARK
 SHEET 3 OF 3
 NATIONAL CAPITAL PARKS - CENTRAL
 NATIONAL PARK SERVICE
 WASHINGTON, DC

DRAWN: BC

DATE: 4/4/2002

TITLE OF SHEET

| | | | | |
|-----|------|---------|-----------|--------------|
| NO. | DATE | PROJECT | SHEET NO. | TOTAL SHEETS |
| 172 | D.C. | | 20 | 172 |

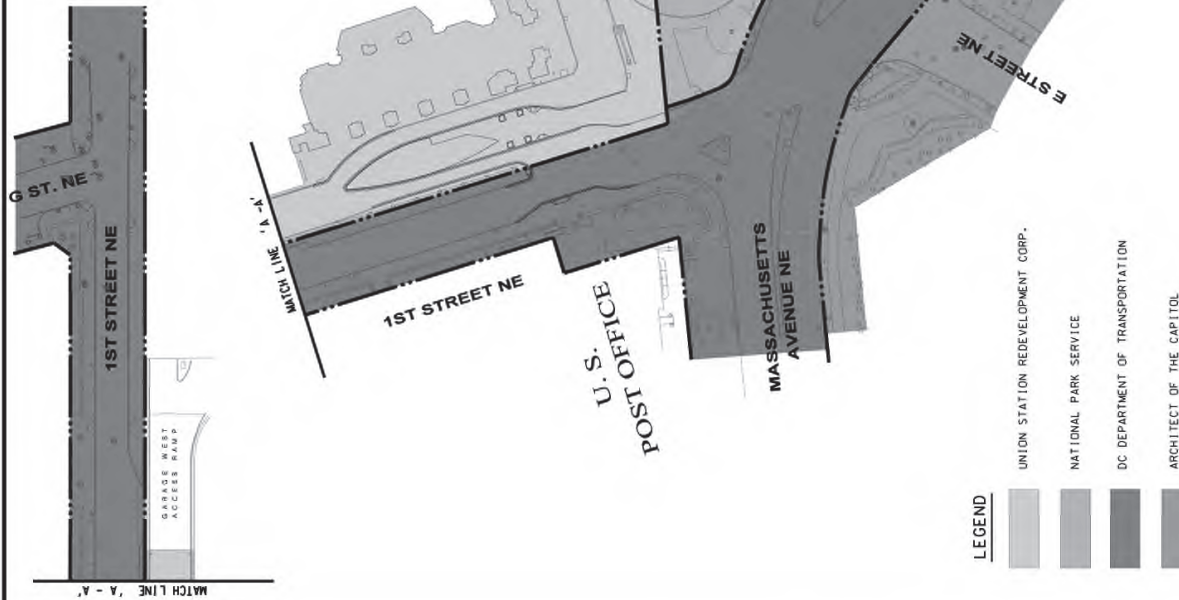

NOTE:
NATIONAL PARK SERVICE PROPERTY
ALONG SHOWN CURBLINES BEGIN AT
THE BACK OF CURB.

FOR INFORMATION ONLY

LEGEND

- UNION STATION REDEVELOPMENT CORP.
- NATIONAL PARK SERVICE
- DC DEPARTMENT OF TRANSPORTATION
- ARCHITECT OF THE CAPITOL
- RIGHT OF WAY (R.O.W.) / PROPERTY LIMIT

SCALE: 1" = 50'

| NO. | DESCRIPTION | NAME | DATE |
|-----|-------------|------|------|
| | | | |
| | | | |
| | | | |
| | | | |

PARSONS
TRANSPORTATION
GROUP
PROFESSIONAL CORPORATION
1100 5TH STREET, N.W. - WASHINGTON, D.C. - 20005

RW-1

| | | |
|---|--|--|
| D.C. DEPARTMENT OF TRANSPORTATION INFRASTRUCTURE PROJECT MANAGEMENT ADMINISTRATION | | PROJECT NAME - A. B. C. DESIGNED BY - J. K. L. CHECKED BY - M. N. O. PROJECT NO. - P. Q. R. DIVISION CHIEF |
| REHABILITATION OF COLUMBUS PLAZA | | DATE FILE |
| EXISTING PROPERTY / RIGHT-OF-WAY MAP | | DATE FILE |



IN REPLY REFER TO:

United States Department of the Interior

NATIONAL PARK SERVICE

National Capital Region

1100 Ohio Drive, S.W.

Washington, D.C. 20242

PUBLIC GATHERING PERMIT

Permit: NCA-NAMA-EVNT24-1408

Date: July 23, 2024

In accordance with Park Regulations as contained in C.F.R., Title 36, Chapter 1, Section 7.96, permission is granted to conduct a public gathering to the following:

Person(s) and/or Organization(s): DC Supporters of Standing Together- Peace and Justice Bloc: Protest Netanyahu

Dates & Time(s): 7/24/2024 12:00 PM

To: 7/24/2024 4:00 PM

Location(s):

Mall: Center Hardscape and Turf Panel #28, Between 4th and 6th Streets

Purpose: The event promotes a future of equality, safety, dignity and freedom for Israelis and Palestinians. We will come together to express our disapproval of Benjamin Netanyahu's visit to Congress and to call on all parties (Israel, Hamas, US Government, etc.) to secure a permanent ceasefire and release of captives.

Anticipated Number or Participants: 400

Person(s) in Charge: (b) (6)

Address(es): (b) (6)

Phone Number: (b) (6)

Mobile Number:

On-Site Contact:

Mobile Number:

This permit is granted subject to the following conditions:

1. Permittee and all participants authorized therein must comply with all of the conditions of this permit and with all reasonable directions of the United States Park Police.
2. All sidewalks, walkways, and roadways must remain unobstructed to allow for the reasonable use of these areas by pedestrians, vehicles, and other park visitors.

PERMITTEE IS RESPONSIBLE FOR READING AND ADHERING TO ATTACHED
ADDITIONAL CONDITIONS.

Additional Conditions

Permit #24-1408

Organization: DC Supporters of Standing Together

Person In Charge: (b) (6)

Location: Mall-Gravel Panel at 4th Street & Turf Panel #26, Between 4th & 6th Streets

Date: July 24, 2024 (12:00 P.M.-4:00 P.M.)

EVENT OVERVIEW: Permittee will assemble on the National Mall-Gravel Panel at 4th Street & Turf Panel #26, Between 4th & 6th Streets, to conduct a “Peace and Justice Bloc: Protest Netanyahu” demonstration. Activity will involve speeches from local grassroots leaders, chanting protest messages, a musical performance featuring the Permittee, the distribution of free literature and the display of banners, signs/placards. At the end of the rally, Permittee has indicated that they will direct participants to disperse to the west in an orderly fashion to avoid crowds gathered closer to the US Capitol. Permittee has estimated a maximum crowd size of (400) participants

Timeline:

| | |
|----------------------------|--|
| 12:00 p.m.-1:00 p.m. | Deliveries/Set up |
| 1:00 p.m.-3:00 p.m. | Peace & Justice Bloc: Protest Netanyahu Rally |
| 3:00 p.m.-4:00 p.m. | Tear down/Load out/Cleanup/Depart |

Equipment list:

Signs/Placards
Three (3) Banners (6' x 3' Each)
One (1) Shade Canopy (10' x 10')
One (1) Tripod w/Small Battery Powered Speaker

A. This permit authorizes use of the Mall-Gravel Panel at 4th Street & Turf Panel #26, Between 4th & 6th Streets, pursuant to the following permit conditions and may be amended by the National Park Service to reflect changing conditions.

B. Permittee is responsible for providing all necessary equipment/objects to conduct this activity. All equipment must be removed from park property immediately following the conclusion of the event. Items left on park property will be considered abandoned property and will not be the responsibility of the National Park Service.

C. Structures:

The Permittee shall insure that all facilities and structures placed on park property adhere to all applicable codes, standards, and regulations including but not limited to BOCA, OSHA, USPHS, IBC 2006, IFC 2006 and ADA, covering requirements including but not limited to safe construction practices, grounding of generators and maintaining access to the Mall.

Additional Conditions
Permit #24-1408

To protect the turf areas, it is strongly encouraged that structures be placed on hardscape areas where it would not impact the turf. The NPS may allow under permit the use of turf areas, however, if the structure and its equipment use the turf protection measures as detailed throughout this permit. All structures must minimize all points that come in contact with the turf.

All structures must be able to withstand a minimum wind gust of 30 mph.

All structures must follow the guidelines below and adhere to National Fire Protection Association codes.

Any temporary structure exceeding over 500 square feet require the submission of engineered drawings stamped by a structural engineer licensed in the United States. Drawings should include tent support lines identified by flagging.

All screws and fasteners used in the construction of structures should be policed during the build and retained during removal.

Screws and fasteners should be made of a non-aluminum metal, enabling a post-event magnet sweep to ensure all pieces are removed from the site.

Tents: To protect the turf, tents should be located on hardscape surfaces including gravel, asphalt, concrete, granite, wood, etc. tents and other similar structures must be secured using cement blocks and/or water-filled ballast tanks. No stakes are permitted on hardscape surfaces. Non-freezing, no-staining liquid approved by the NPS (water treated with bio-degradable antifreeze) in plastic containers shall be used as weighing elements. No sandbags are permitted for this purpose.

At takedown, all water filled ballast tanks must NOT be pumped to the nearest catch basin (located within the curbs) or to the area drains located throughout the hardscape. Tanks may not be drained into the turf or pumped in gravel areas. This prevents creation of muddy puddles and soft areas in the turf and also limits runoff of gravel into area drains.

If approval is granted by NPS, no tent stakes may penetrate the ground surface by more than 18 inches. Use of stakes longer than this requires coordination through the Turf Management Specialist, National Mall & Memorial Parks, at (202) 245-4685.

Tents must be constructed of fire-retardant material. A certificate of fire-retardant material must be provided as confirmation to the NPS

Tents should be placed at least 5 to 10 feet apart.

Clearance. A minimum 10ft. clearance must be maintained from tents to any flammable or combustible materials or vegetation.

D. Resource Protection:

Pursuant to 36 CFR 7.96(g)(5)(C)(xii), the alteration, adaptation, damage, or injuring, and/or removal of park resources or facilities are prohibited. No holes may be dug and no item, including signs or banners, may be attached to park trees, plantings, benches, or other park property. The alteration, adaptation, damage or injuring, and/or removal of park resources or facilities are prohibited.

E. LOGISTIC VEHICLES WILL BE ALLOWED TO PULL ONTO THE GRAVEL WALKWAYS, TO UNLOAD AND LOAD HEAVY EQUIPMENT. VEHICLES WILL NOT BE ALLOWED TO DRIVE AND/OR PARK ON THE GRASS. Logistical vehicle access onto the Mall gravel walkways must be coordinated with Sgt. (b) (6), (b) (7)(C) and/or Sgt. (b) (6), (b) (7)(C), United States Park Police. Permittee must call (202) 610-7092 to acquire any/all vehicle access passes.

F. Specific Conditions for Mall-Center Turf Panels-3rd to 14th Street:

To protect the turf areas, it is strongly encouraged that structures be placed on the Mall's hardscape areas where it would not impact the turf. The NPS may allow under permit the use of turf areas, however, if the structure and its equipment use the turf protection measures as detailed throughout this permit. All structures must minimize all points that come in contact with the turf.

Logistical vehicles accessing the Mall with appropriate Vehicle Access Passes must drive at least five feet (5') away from the Mall center panel's granite curbs.

Event vehicles of any kind (delivery, cranes, forklifts, golf carts, trailers, exhibit trailers, etc. are not allowed on the Mall turf of curbs.

Back of house, trailers, bone yards, generators portable toilets etc. are not permitted on the turf panels or curbs.

Vehicle mounted signs, LED screens, media towers and light towers are not permitted on the turf panels or curbs.

Equipment used for set up must be kept at least two.five feet (2.5') away from the granite curbs.

All temporary facilities approved for placement on the Mall center panels must be hand carried onto the panels from the gravel walkways.

Stakes required for anchoring tents, scaffolding and other structures approved for placement on the Mall center turf panels must be eighteen inches (18") or smaller.

Additional Conditions
Permit #24-1408

No staking within the designated “No-staking Zone” to protect irrigation lines. The no staking zone is the area at least ten feet (10’) away from the edge of the granite curbs and at least ten feet (10’) away from either side of the center line of the Mall turf panel. Specific areas must be designated on approved site plan prior to staking.

Planting strips, along the 3rd and 4th Street edges of the turf panel, are no staking zones

Water filled ballast tanks and/or cement blocks may not be used on the turf.

Appropriate turf cover/ground protection material approved by NPS, is required for the setup of chairs or other seating on the turf panels.

Permittee is encouraged to secure products such as Terraplas, Terratile and Matrax LD or equal that is ADA-compliant, interlocking mats that are translucent and allow UV light to pass through to the grass below. The products must either be perforated or ribbed, allowing for ventilation and some moisture access to the turf below. Material to be used must be approved in advance by NPS. **Plywood cannot be used as turf cover/ground protection.**

G. **Gravel Walkways:** Stages, stands and other facilities approved for placement on gravel walkways between 3rd and 14th Streets must be supported by 3/4-inch plywood or similar material. ***Material to be used must be approved in advance by NPS.***

H. Unloading and loading of all other equipment must take place from the street curb only. All vehicles must park in designated, available public spaces. **NOTE: Madison and Jefferson Drives are metered parking areas. Permittee is responsible for paying \$2.30 per hour, during the hours of 7:00 a.m.-8:00 p.m. each day.**

I. **Generators/electricity:**

No electricity is available on site. Permittee may provide own gasoline and/or solar powered generator. The fueling/refueling of gasoline powered generators on parkland is prohibited. The storage of additional fuel is prohibited. **Generators must be placed on the gravel walkway and 3/4” plywood or similar material must be placed underneath the generator to protect the gravel areas.**

Generators must also be enclosed with a perimeter security fence/barricade at least three feet (3’) in height. The cord must be in good condition, of sufficient gauge to accommodate the electrical load of equipment and must be properly grounded.

All wires must be covered by mats and/or yellow jackets to prevent tripping hazards. When used for crossing of roadways or pedestrian paths, these devices must meet applicable ADA Standards.

Additional Conditions
Permit #24-1408

All cables, power lines, etc. shall be run in an orderly manner and contained in matted yellow jackets that provide for safety and accessibility. No power lines can be strung between trees.

Electrical Work/Appliances.

OUTDOOR electrical cords, receptacles, connections and or appliances shall be Underwriters Laboratories (UL), Listed and Labeled and or Factory Mutual (FM) approved for wet locations or OUTDOOR use and meet NFPA 70 National Electrical Code NEC. All shall be arranged to minimize the tripping hazard and shall be permitted to be covered with non-conductive matting, provided that the matting does not constitute a greater tripping hazard than the uncovered cables. NFPA 70:525.20 (G).

J. Special attention is drawn to the last sentence, item #7, last page of this permit, concerning sound amplification. All sound amplification equipment shall be limited such that it will not unreasonably disturb nonparticipating persons in, or in the vicinity of, the area.

K. The Permittee will be responsible for any injuries and/or damage to government property occurring as a result of this permitted activity.

L. Permittee does not have exclusive use of the area including sidewalks and roadways. No interference with the pedestrian traffic and no blocking entrances, sidewalks, nor driveways allowed. No impeding vehicular traffic permitted. All areas remain open to the general public at all times.

M. Sales: Special attention is drawn to item #4, last page of this permit, concerning fees collected and donations solicited on parkland. No merchandise may be sold or offered for sale except for message bearing books, newspapers, leaflets, pamphlets, buttons, and bumper stickers. Sales areas can be no larger than 6' wide by 15' long by 6' high and can have only one table 2 ½ 'by 8', or 4' by 4'. **There are no sales associated with this permitted activity.**

N. **Trash/Debris Collection & Removal:**

Permittee is encouraged to clear all trash and debris generated as part of the permitted activity from the permit site grounds immediately after the conclusion of the event. Open trash and recycling containers on the Mall, between 3rd and 14th Street should be used for this effort. Permittee may provide additional trash and recycling receptacles to prevent the overflow of Mall containers. Trash receptacles must be placed on hard, paved surfaces and must not overflow with trash or debris. Use of **clear trash bags** is required for all trash receptacles used for the event.

O. Drones, balloons, and glass beverage containers are prohibited on parkland.

Additional Conditions
Permit #24-1408

P. All proposed amendments or additions to this permit and all proposed locations of vehicles, equipment, storage, installations of any kind, areas of activity, work and power plans shall be submitted to the National Park Service for prior written approval. These proposals shall be in map or diagram form suitable for on the ground inspection. Placement of tents, trailers, stages, sound towers and any other detailed and specific equipment shall be indicated on the site map and will be provided to the National Park Service prior to installation.

Q. **Adverse Weather Policy:**

When there is a threat to public health or safety, the Superintendent and/or his/or her designee, may close the National Mall or an event being held there for such duration as determined necessary to ensure the safety and wellbeing of the public. Such situations have occasionally occurred in the past where park areas have been closed due to severe weather warning of heavy snow and thunderstorms with lightning and high winds. Where an area is ordered closed due to a weather-related public safety threat, pursuant to 36 CFR 2.32(2) people must comply with official directions to leave the closed area and relocate to safer sheltered locations.

R. **Additional Permits:** Person in charge is responsible for contacting the Metropolitan Police Department, (202) 671-6522, to obtain the necessary paperwork and/or permission for the use of city streets.

S. Contact (b) (6), (b) (7)(C) National Mall & Memorial Parks, (b) (6), (b) (7)(C) to finalize any Permit logistics. Contact Sgt. (b) (6), (b) (7)(C) and/or Sgt. (b) (6), (b) (7)(C), U.S. Park Police, (b) (6), to finalize any police logistics.

T. If the Permittee decides to cancel or substantially modify its event, the Permittee must immediately advise both the United States Park Police Special Events Sergeant at (202) 610-7092 and the Division of Park Programs at (202) 245-4715.

U. A copy of this permit must be carried at all times by the Permittee while operating under the authority granted.

3. All laws, rules and regulations applicable to the area covered by this permit remain in effect.
4. No fee may be collected, donation solicited, or commercial activity conducted. No items may be sold or offered for sale except for books, newspapers, leaflets, pamphlets, buttons and bumper stickers which contain a message related to your demonstration or special event. No other merchandise may be sold or offered for sale. A stand or structure used for the sale of permitted items may not exceed one table per site, which may be no larger than 2 1/2 feet by 8 feet or 4 feet by 4 feet. The dimensions of the sales site may not exceed 6 feet wide by 15 feet long by 6 feet high.
5. The area should be left in substantially the same condition as it was prior to the activities authorized herein, and all litter shall be placed in the trash containers provided.
6. This permit is applicable only for the use of the area designated above, and during the times designated above, or in any area as may hereafter be designated by the United States Park Police.
7. The use of sound amplification equipment, other than hand-portable sound amplification equipment to be used for crowd control purposes only, is prohibited on the White House Sidewalk (South 1600 Pennsylvania Avenue, NW, sidewalk between East Executive Avenue and West Executive Avenue). All sound amplification equipment shall be limited so that it will not unreasonably disturb nonparticipating persons in, or in the vicinity of, the area.
8. The National Park Service reserves the right to immediately revoke this permit at any time should it reasonably appear that the public gathering presents a clear and present danger to the public safety, good order or health, or if any conditions of this permit are violated.

(b) (6), (b) (7)(C)

Area Director

NPS National Capital Area

Interior Region I

(b) (6), (b) (7)(C)

Division of Permits Management

National Mall & Memorial Parks

- Metrorail Entrance
- Statue
- Visitor Information
- Restrooms
- Railroad
- Building
- Water



TITLE OF SHEET

NATIONAL MALL

4th Street to 7th Street

NATIONAL CAPITAL PARKS - CENTRAL
NATIONAL PARK SERVICE
WASHINGTON, DC

DRAWN: BC
DATE: 1/14/2003

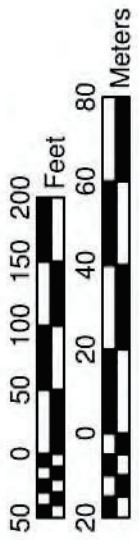

I want to follow up on an earlier discussion regarding the responsibilities and availability of marshals during ANSWER Coalition demonstrations held on parkland. We appreciate the ANSWER Coalition's willingness to provide 200 demonstration marshals wearing armbands and vests to help manage the anticipated crowd of 5000+ demonstrators who are expected to gather between 3rd-

6th Street on Pennsylvania Avenue, John Marshall Park, Meade Statue area, Penn Ave Sidewalks (north and south) and Reservation 553. I understand from your demonstration document the marshals will be assigned in various areas during the demonstration. Previously, you stated some marshals will be stationed around the Meade statue area and John Marshall Park to help prevent damage to park resources, similar to the vandalism that occurred in Lafayette Park on June 8. The NPS appreciates your willingness and commitment to protect the natural and cultural resources of the parks.

For each of the NPS sites you are requesting to permit, please furnish the **name** and **contact phone number** of the zone captains that will be responsible for interfacing with USPP, NPS and other government officials. You are required to provide a different zone captain for each area with separate mobile phone number. While they don't serve in a law enforcement capacity, the zones captains should maintain order of the crowd in their assigned area, with the assistance of assigned zone marshals. Do you hold a safety briefing with your marshals prior to event - if so what time and location?

The five zones established by the NPS are:

John Marshall Park, (Zone 1): 1 Zone Captain and a minimum of 10 marshals
Meade Statue area, (Zone 2): 1 Zone Captain and a minimum of 5 marshals (relinquished but indicated marshals will still be station in the park for crowd management)
Pennsylvania Ave Sidewalks (south) (Zone 3): 1 Zone Captain and a minimum of 5 marshals
Pennsylvania Ave Sidewalks (north) (Zone 4): 1 Zone Captain and a minimum of 5 marshals
Reservation 553 (Zone 5): 1 Zone Captain and a minimum of 5 marshals
Columbus Plaza (Zone 6): 1 Zone Captain and a minimum of 10 marshals

Please use the attached maps to assign the Zone Captain and the tentative location of each marshal. I understand you have more than 200 demonstrations and likely all zones will have more than the minimum.

Pursuant to 36 CFR 7.96 (g)(5)(xii) A permit may contain additional reasonable conditions and additional time limitations, consistent with this section, in the interest of protecting park resources, the use of nearby areas by other persons, and other legitimate park value concerns. Based on recent demonstrations conducted by ANSWER Coalition the request to have zone captains and marshals stationed near the park statutory resources is reasonable. Please note if you do not have a sufficient number of zone captains' certain requested areas may not be permitted.

Additional follow up items from today's 3 pm call:

This email acknowledges you are relinquishing the Meade Statue (Zone 2) but will have security marshals stationed at the Meade Statue but are still permitting the Pennsylvania Avenue sidewalks between 3rd-4th Streets directly in front of the Meade Statute.

Please provide in writing ANSWER Coalition's request to use Columbus Plaza on July 24, from 2 pm - 4 pm. Please provide an equipment list for Columbus Plaza

This email confirms ANSWER Coalition will not march to Lafayette Park

Provide the names of the two security officers with contact number in addition to the zone captains information.

I look forward to receiving the information. Please confirm receipt of this email.

(b) (6), (b) (7)(C)

Park Ranger
Division of Permits Management
Office: (b) (6), (b) (7)(C)
Mobile: (b) (6), (b) (7)(C) (best number)



"If you believe in a cause, be willing to stand up for that cause with a million people or by yourself". Otis S. Johnson

From: [Van Dyke, Timothy W](#)
To: [Taylor, Jessica M](#); [Cunningham, Christopher](#); [Schneider, Jeffrey](#); [Brecht, Scott H](#); [Woods, Lelani S](#); [Hilsher, Frank A](#); [Evans, David J](#); [Piombo, Albert M](#); (b) (6), (b) (7)(C);
(b) (6), (b) (7)(C);
(b) (6), (b) (7)(C); [Twinn, Thomas](#); (b) (6), (b) (7)(C); [Dingeldein, James E](#); [Piombo, Albert M](#); (b) (6), (b) (7)(C); [Hofflinger, Jonathan D](#); [Bahamonde, Daniel A](#); (b) (6), (b) (7)(C);
(b) (6), (b) (7)(C); [Lamond, David J](#); (b) (6), (b) (7)(C);
Subject: ANSWER COALITION Demonstration / Dignitary Visit Incident Brief
Date: Tuesday, July 23, 2024 9:20:13 AM
Attachments: [Outlook-0mwp22p0.png](#)
[Outlook-52dtrzo2.png](#)
[Outlook-oaludchi.png](#)
(b) (7)(E)
[24-1278 ANSWER Coalition.pdf](#)

All,

Please see the following documents for the ANSWER COALITION Demonstration / Dignitary Visit which occurs on July 24, 2024:

- USPP Incident Brief
- NPS Record of Determination

NPS has not finalized the permit. It is anticipated this will be completed and released to the organizer later today. I will distribute it to this thread when it becomes available.

The USPP Special Detail will be released Force-wide today at 1400 hours.

Lieutenant Timothy Van Dyke
Commander - Special Events Unit
United States Park Police
1100 Ohio Drive, SW
Washington, DC 20024



Learn more about how to [Become a United States Park Police officer!](#)
[Apply here](#) to become a United States Park Police Officer!



United States Department of the Interior

NATIONAL PARK SERVICE
National Mall and Memorial Parks
1100 Ohio Drive SW
Washington, DC 20242



IN REPLY REFER TO:

10.C

July 21, 2024

Record of Determination for a temporary restriction of access and closures to certain parklands in Rock Creek Park and National Mall and Memorial Parks associated with the Official visit of the United States Secret Service Protectee.

Pursuant to 36 C.F.R. § 1.5, beginning the night of Sunday, July 21, 2024, the National Park Service is imposing a temporary closure of certain designated parklands for events associated with a Secret Service Protectee. This closure will be in effect from Sunday, July 21 through Friday, July 26, 2024, as delineated in the attached map and as further delineated by fencing.

Specifically, there will be a temporary restriction of vehicular access of the following locations from Sunday, July 21 at approximately 11:30 pm to approximately 12:30 am on Friday, July 26, 2024:

National Mall and Memorial Parks

- Parkway Drive NW, between Rock Creek and Potomac Parkway NW and Lincoln Memorial Circle, NW. (the adjacent sidewalks and trails will remain open to pedestrian traffic)
- Rock Creek Parkway NW, between Virginia Avenue NW and the Potomac River Freeway NW.

Rock Creek Parkway

- Thompson Boat Center Parking Lot, 2900 Virginia Avenue, NW.

The following parklands will temporarily be closed to pedestrian access:

- The Washington City Canal Outfall section of the Rock Creek Trail.
- Thompson Boat Center Parking Lot, 2900 Virginia Avenue, NW.

In addition, at approximately 4:30 am on July 24 until approximately 1:00 pm on July 24, 2024, the following areas of Rock Creek Park will be temporarily closed to pedestrian access:

- Portions of Glover Archbold Park Trails, adjacent to the Washington Hebrew Congregation, specifically the Glover Archbold Park Trail and the Massachusetts 39th Trail, adjacent on the west to Massachusetts Avenue NW and on the east to 39th Street NW.

These closures come at the request of the United States Secret Service and are necessary to provide a secure staging area as well as a secure perimeter with sufficient stand-off distance to protect the Secret Service Protectee during activities in the District of Columbia. The temporary restrictions are also necessary to permit the Secret Service to perform security sweeps of the area, facilitate arrivals and departures, allow for security screening, and restrict access to the areas and buildings surrounding the protectee's activities.

Less restrictive measures will not suffice due to the Secret Service's security-based assessment that these park areas need to be kept clear. It is further anticipated that Secret Service personnel will temporarily restrict public access in these areas during the installation and removal of anti-scale fencing. These restrictions are expected to begin on Sunday, July 21, 2024, from approximately 11:30 p.m. until the removal of fencing by approximately 12:30 am on Friday, July 26, 2024. These public access restrictions are necessary during fence installation to ensure the safety of the public as well as the personnel engaged in installation. A copy of the Secret Service's map dated July 20, 2024, is attached and incorporated by reference.

This temporary and partial closure is not of a nature, magnitude and duration that will result in a "significant alteration in the public use pattern". Further, the closure will not adversely affect the park's natural, aesthetic or cultural values and is not of a highly controversial nature.

Rather, closures such as these are commonplace for summits and other occasions at which heads of state meet with government officials and are necessary to provide the public with as much access as possible to park land while also providing for the security the Secret Service has deemed necessary for this event.

Accordingly, the National Park Service determines publication as rulemaking in the Federal Register is unwarranted under 36 C.F.R. § 1.5(b). This is consistent with hundreds of earlier partial and temporary park closures or public use limitations, the legal opinion of the Office of the Solicitor, and judicial adjudications. *Mahoney v. Norton*, No. 02-1715 (D.D.C. August 29, 2002), plaintiff's emergency motion for injunction pending appeal denied *Mahoney v. Norton*, No. 02-5275 (D.C. Cir. September 9, 2002) (per curiam); *Picciotto v. United States*, No. 99-2113 (D.D.C. August 6, 1999); *Picciotto v. United States*, No. 94-1935 (D.D.C. September 9, 1994); *Picciotto v. Lujan*, No. 90-1261 (D.D.C. May 30, 1990); *Picciotto v. Hodel*, No. 87-3290 (D.D.C. January 26, 1988); *Spiegel v. Babbitt*, 855 F.Supp. 402 (D.D.C. 1994), *aff'd in part w/o op.* 56 F.3d 1531 (D.C. Cir. 1995), reported in full, 1995 US App. Lexis 15200 (D.C. Cir. May 31, 1995). Pursuant to 36 C.F.R. § 1.7, notice of this temporary and partial closure will be made through media advisories, maps, and by posting at conspicuous locations in the affected park areas. Finally, pursuant to 36 C.F.R. § 1.5(c), this determination is available to the public upon request.

(b) (6), (b) (7)(C)

7/21/24

(b) (6), (b) (7)(C) Superintendent
National Mall and Memorial Parks

Date

(b) (6), (b) (7)(C)

7/21/24

(b) (6), (b) (7)(C) Acting Superintendent
Rock Creek Park

Date

Enclosure



**ANSWER COALITION
1st Amendment Demonstration
(24-1278)**



Incident Brief

Wednesday July 24, 2024

Jessica Taylor
Chief of Police

Account Number
(b) (7)(E)

| | | | |
|---|---|-------------------------|-------------------------|
| Incident Briefing | 1. Incident Name | 2. Date Prepared | 3. Time Prepared |
| | ANSWER Coalition | 7/22/2024 | 0100 hrs |
| 4. Operational Period (Date and Time) and Participation (number of people) | | | |
| 7/24/2024 | | 0600- Relief | 5,000 |
| 5. Incident Objectives | | | |
| | To safeguard and protect human life | | |
| | To safeguard and protect Park resources, both natural and cultural | | |
| | To maintain law and order throughout NPS areas throughout the duration of this operational period | | |
| | To ensure that any lawful demonstrations, either pro or counter, occur without disruption | | |
| | To safeguard and protect agency personnel | | |
| | To keep costs commensurate with incident needs | | |
| 6. Additional Information for Incident | | | |
| <p>General Overview: On Wednesday 07/24/24 at approximately 1100 hours, ANSWER Coalition will be gathering on Pennsylvania Avenue, John Marshall Park, and the Meade Statue for a First Amendment Demonstration to "stop the genocide in Gaza". The group also intends to protest an address by the PM of Israel to a joint session of Congress. A march will occur after the rally and programming has concluded. USPP will provide site security of National Park Service properties, traffic control, crowd control, tactical response, plain clothes operations, and other law enforcement services as needed.</p> | | | |
| <p>Accounting: <u>All work (regular and overtime) performed in connection with this special event will be charged to account:</u> (b) (7)(E) The following supervisors shall ensure that a 10-344 is completed for all Force personnel assigned to them. All reports shall be completed and submitted to Ofc. (b) (6), (b) (7)(C) at (b) (6).</p> | | | |
| <p>Communications: USPP Admin USPP will have a representative at the MPD JOCC. USPP will have a representative at the USCP JOCC. USPP will have a representative at (b) (7)(E).</p> | | | |
| <p>EOD: (b) (7)(E)</p> | | | |
| <p>Evacuations/Safe Haven: For a weather related incident, USPP personnel working the event will be able to take shelter in government vehicles. All participants of the event will utilize available public access buildings for shelter as it is not provided by the organizer. For a critical incident, event participants will be directed away from the incident to safety. The direction of the evacuation will ultimately be determined by the Incident Commander based on the totality of the circumstances.</p> | | | |
| <p>Logistics: Vehicles will be provided by USPP District 1 as needed for transportation of personnel to and from the site. No meals provided. Supervisors are encouraged to provide breaks for food and water as needed.</p> | | | |
| <p>March Route: 3rd Street NW, East on Constitution Ave NW, North on Louisiana Ave, and terminate in Columbus Plaza.</p> | | | |

Marshals / Security: The organizer will have 200 marshals that will be assigned to permitted areas to maintain order. They will be identified by arm bands and vests.

Media: The organizer will have a media staging area on Constitution Ave NW west of 3rd Street on city property.

Medical: The organizer will have a First Aid tent which will be staffed by a team of health care professionals. They will also have a Hydration tent for water distribution. These will be located in John Marshall Park.

DCFEMS will be staging additional assets in the area of the National Mall in anticipation of increased visitation. DCFEMS will provide 2 Command Supervisors, 4 medic units, and 2 UTV's for patient extraction.

Permit Holders: 24-1278 ANSWER Coalition - (b) (6)

Traffic / Road Closures:USPP will be closing Madison and Jefferson Drive from 3rd to 7th Street in anticipation of increased visitation and a march that will be conducted after the rally has ended. MPD will be enacting road closures on Pennsylvania Ave between 3rd and 6th Street NW. MPD will be providing intermittent road closures to facilitate a First Amendment march.

Notes: The organizer indicated an interest in deploying a banner (with breaks) on MPD roadways to conduct their 1st Amendment Demonstration. The march route may move in a direction which goes around the US Capitol. The organizer has indicated to NPS they are not going to be performing acts of civil disobedience. Organizer indicated 31 buses are transporting people to the rally and parking at Union Station.

(b) (7)(E)

(b) (7)(E)

8. Timeline

0600 hours: MPD reports to road closures

0600 hours: USPP reports to road closures

0600 hours: USPP Special Detail Roll Call

1000 hours: Pre-rally begins

1100 hours: ANSWER Rally begins

1300 hours: March departs rally site

1600 hours: March ends

TBD hours: USPP Detail concludes

8. Intelligence Report

(U//FOUO) On 24 July 2024, various groups will meet in the vicinity of the U.S. Capitol to demonstrate against Israeli Prime Minister Benjamin Netanyahu as he addresses a Joint Session of Congress. Large crowds possibly reaching up to 15,000 people are expected. While this total attendance figure will be realized through multiple smaller groups, the main focus of the day's events will be centered upon the ANSWER Coalition and their permitted event planned to take place at Pennsylvania Ave. and 3rd Streets, NW. Exact plans for the event are still being finalized with event planners, but the rough run of show entails speakers from the stage area followed by a possible musical performance and then a march with an as of yet undetermined route and destination.

(b) (7)(E)

9. Attachments

[See Maps](#)

10. Personnel Assigned

Special Detail

11. Prepared by (PSC)

Lieutenant Timothy Van Dyke

12. Approved by (PSC)

Major Frank Hilsher

ICS-202A-PP

ANSWER Coalition

Map Key

- Closure Area
- USPP Vehicle
- REACT 0600
- REACT 1200
- CDU

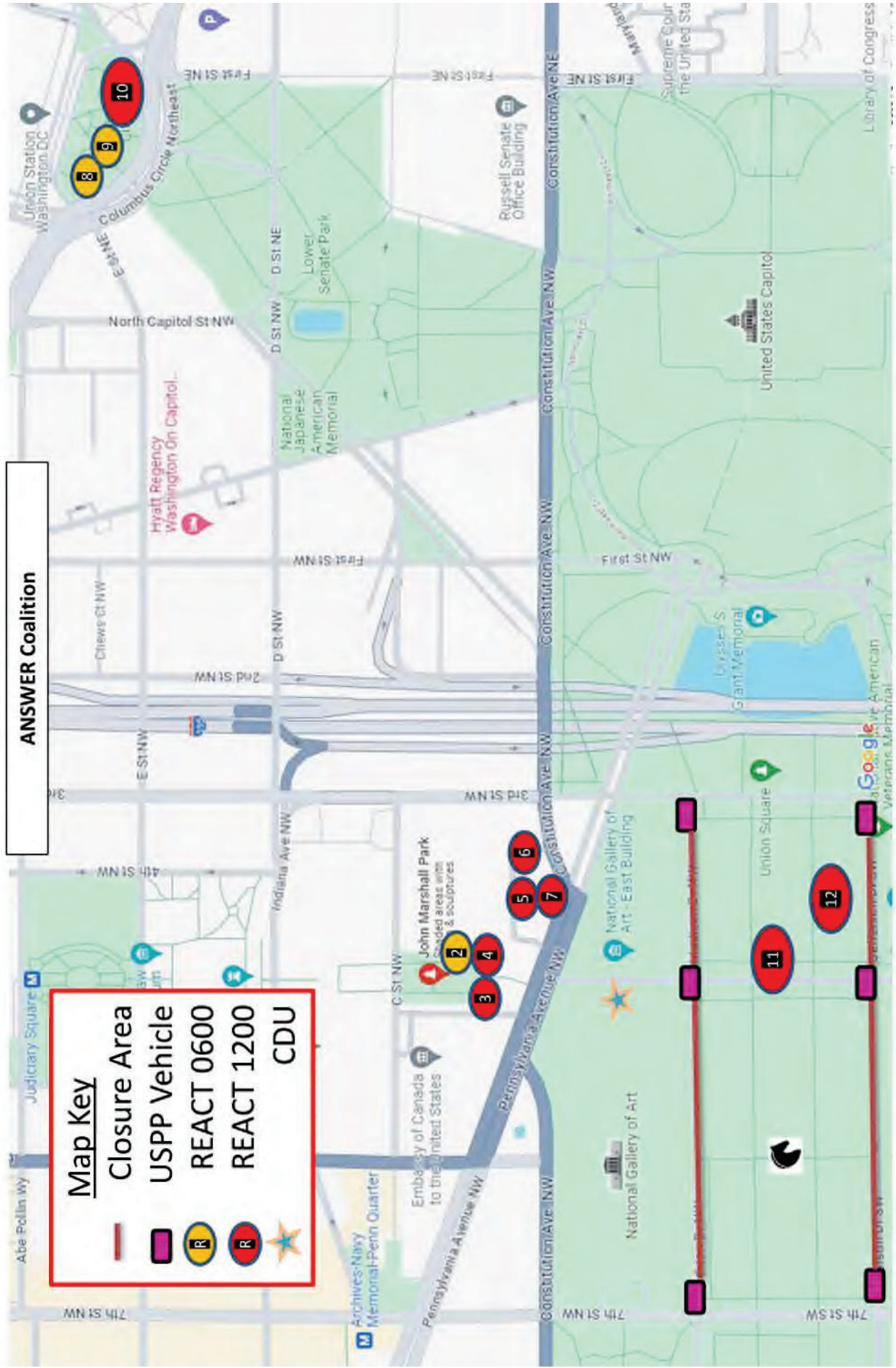

**First Amendment Activity
7/24/24**

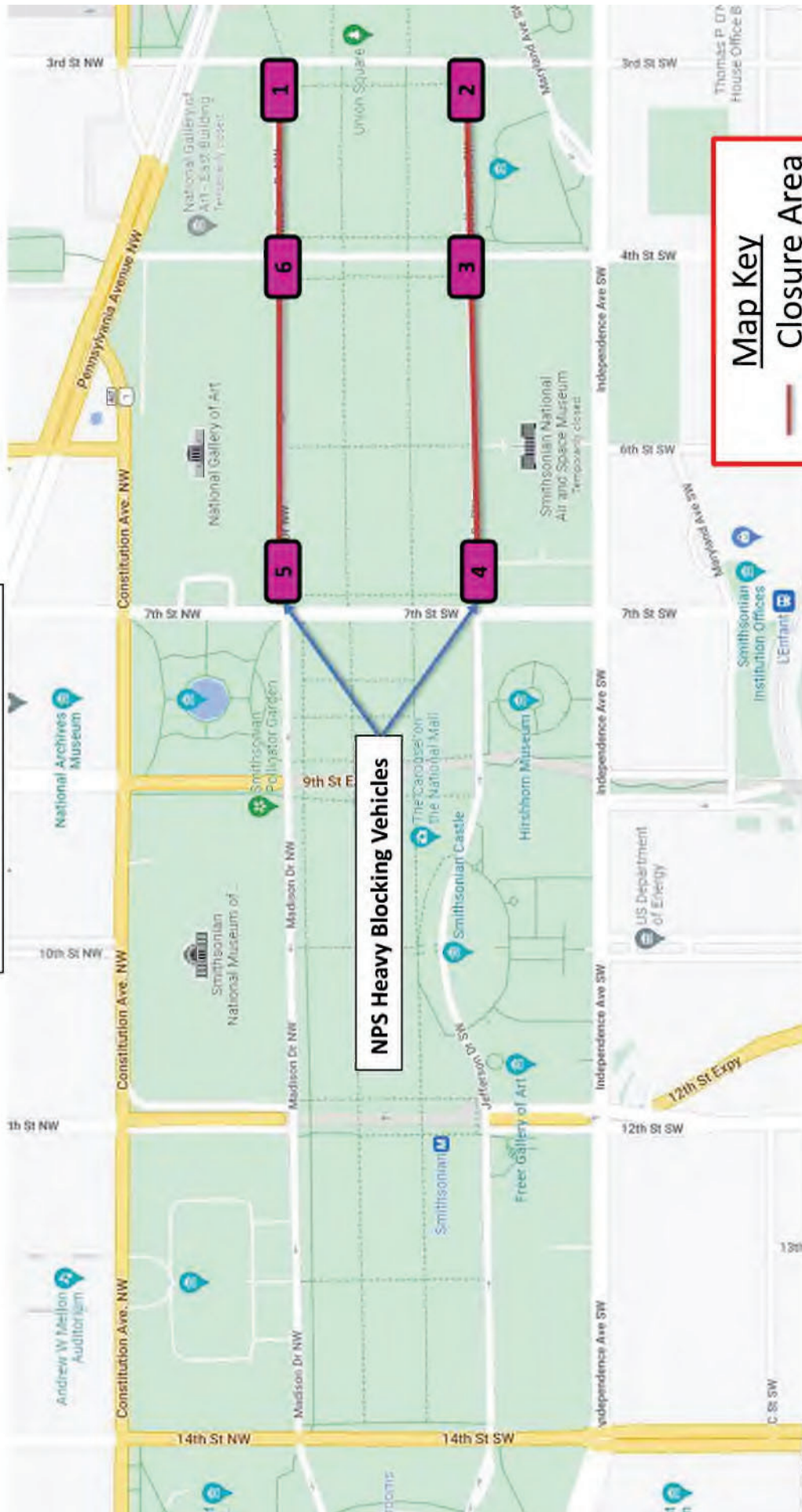

NPS Heavy Blocking Vehicles

Map Key

- Closure Area
- USPP Vehicle

ANSWER Coalition
March Route 7/24/24

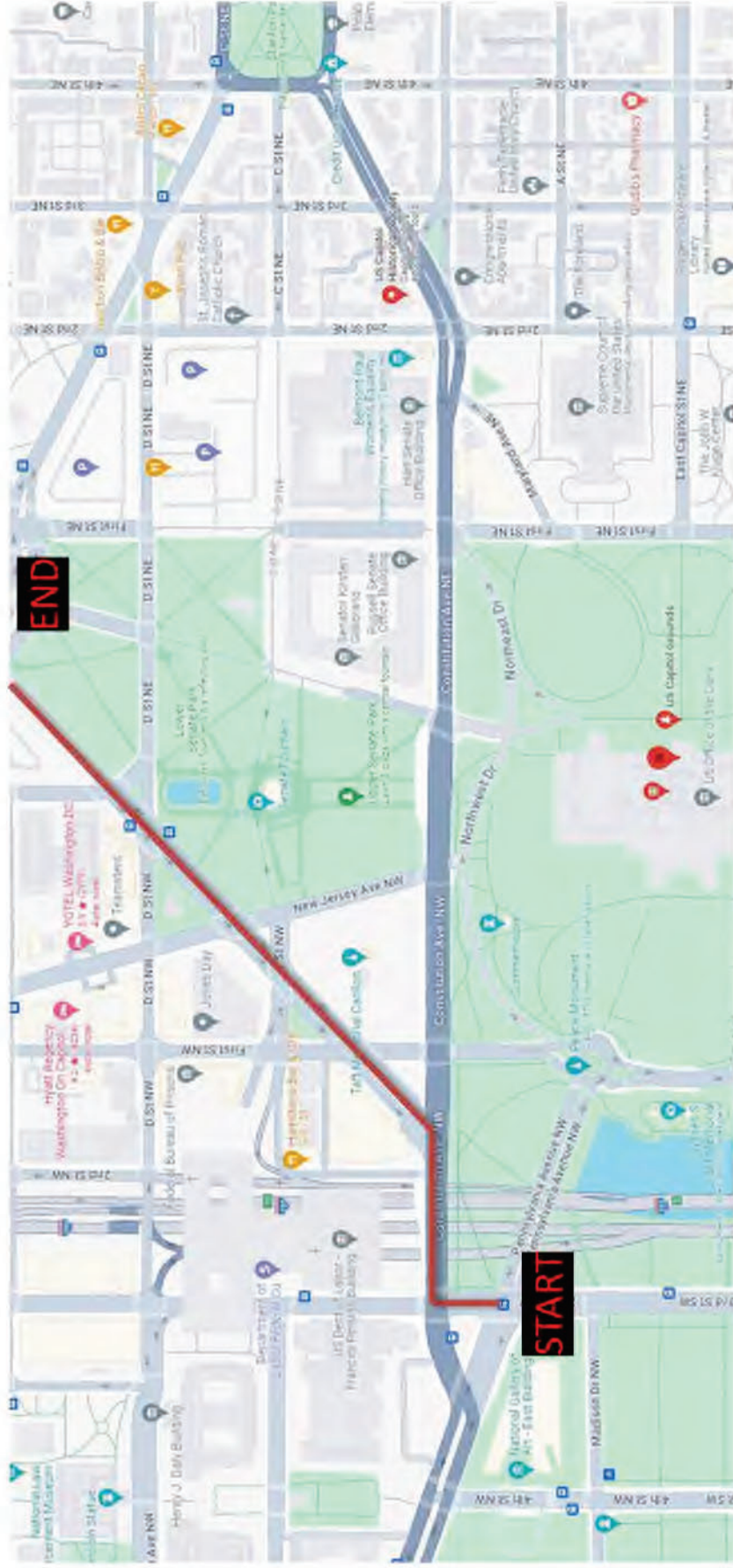

From: (b) (6), (b) (7)(C)
To: NPS USPP Intel Group; Hilsher, Frank A; Hofflinger, Jonathan D; Lamond, David J; (b) (6), (b) (7)(C) Van Dyke, Timothy W; (b) (6), (b) (7)(C) Twiname, Thomas; Olson, Jessup; Piombo, Albert M; (b) (6), (b) (7)(C); Bahamonde, Daniel A; (b) (6), (b) (7)(C)
Cc: Taylor, Jessica M; Cunningham, Christopher; Schneider, Jeffrey; Woods, Lelani S; Brecht, Scott H
Subject: Event Info 7.24.2024
Date: Wednesday, July 24, 2024 6:58:40 AM
Attachments: 24-1278 ANSWER Coalition John Marshall Park, Columbus Plaza, Penn Ave north and south sidewalks 3rd-5th, se .pdf
24-1244 (b) (6), (b) (7)(C) pdf
24-1408-DC Supporters of Standing Together.pdf
USPP 7.24.2024 WDC Demonstration List.pdf

Attached is our latest list of events as well as copies of the three NPS permits that have been issued. Permit applications 24-1395 and 24-1289 are both listed in the NPS system as having been cancelled (NFI).

Also attached is our most current list of events occurring today in and around the Capitol. This information is being presented with the understanding that once events begin, it is highly likely that groups will split and merge and conditions on the ground will bear little to no resemblance of this initial plan.

(b) (6), (b) (7)(C)

(b) (6), (b) (7)(C)

(b) (6), (b) (7)(C)

(b) (6), (b) (7)(C)

Cell: (b) (6)

STE: (b) (6), (b) (7)(C)

(b) (6)

(b) (6)

(b) (6)

WARNING: THIS CORRESPONDENCE SHOULD BE TREATED AS LAW ENFORCEMENT SENSITIVE (LES) AND IS "FOR OFFICIAL USE ONLY" (FOUO). LES INFORMATION SHOULD NOT BE FURNISHED OUTSIDE THE U.S. GOVERNMENT OR PUBLIC SAFETY. THE INFORMATION CONTAINED WITHIN MAY BE EXEMPT, UNDER 5 U.S.C. 552 (b) (7).



IN REPLY REFER TO:

United States Department of the Interior

NATIONAL PARK SERVICE

National Capital Region

1100 Ohio Drive, S.W.

Washington, D.C. 20242

PUBLIC GATHERING PERMIT

Permit: NCA-NAMA-EVNT24-1278

Date: July 23, 2024

In accordance with Park Regulations as contained in C.F.R., Title 36, Chapter 1, Section 7.96, permission is granted to conduct a public gathering to the following:

Person(s) and/or Organization(s): ANSWER Coalition

Dates & Time(s): 7/24/2024 5:00 AM

To: 7/24/2024 4:00 PM

Location(s):

Columbus Plaza; John Marshall Park; Pennsylvania Avenue North Sidewalk, 3rd - 5th Street

Pennsylvania Avenue South Sidewalk, 3rd - 5th Street

Purpose: Stop the genocide in Gaza

Anticipated Number or Participants: 5000

Person(s) in Charge: (b) (6)

Address(es): (b) (6)

Phone Number: (b) (6)

Mobile Number:

On-Site Contact: (b) (6)

Mobile Number: (b) (6)

On-Site Contact: (b) (6)

Mobile Number: (b) (6)

On-Site Contact: (b) (6)

Mobile Number: (b) (6)

*Organizer refused to provide specific locations for onsite contacts.

This permit is granted subject to the following conditions:

1. Permittee and all participants authorized therein must comply with all of the conditions of this permit and with all reasonable directions of the United States Park Police.
2. All sidewalks, walkways, and roadways must remain unobstructed to allow for the reasonable use of these areas by pedestrians, vehicles and other park visitors.

PERMITTEE IS RESPONSIBLE FOR READING AND ADHERING TO ATTACHED
ADDITIONAL CONDITIONS.

PERMIT: #24-1278

ISSUED TO: ANSWER COALITION

LOCATION: JOHN MARSHALL PARK, PENNSYLVANIA AVENUE NHS, NORTH AND SOUTH
SIDEWALKS, AND COLUMBUS PLAZA

DATE: JULY 24, 2024 (5:00 AM –4:00 PM)

Activity Overview:

The ANSWER Coalition will conduct a demonstration to stop the genocide in Gaza. The demonstration will occur from 10:00 am – 1:00 pm feature speeches and conclude with a march to Columbus Plaza. The primary location for the demonstration is on the closed portion of Pennsylvania Avenue between 3rd-5th Streets. There will be portable restrooms, hydration station, button sales area and a first aid stand setup in John Marshal Park. The Pennsylvania Avenue sidewalks between 3rd-5th Street will be used as overflow area for participants. The maximum estimated number of participants is 5000.

Timeline Overview**Pennsylvania Avenue -3rd -4th Street (MPD Jurisdiction)**

| | |
|---------------------|--|
| 5:00 am | Setup of Stage and delay towers |
| 6:00 am - 12:00 pm | Staggered bus drops on C Street between 4 th -6 th |
| 10:00 am – 11:00 am | Pre-rally music and speeches |
| 11:00 am – 1:00 pm | Demonstration |
| 1:00 pm 1:15 pm | March to Columbus Plaza |

John Marshal Park and Pennsylvania Avenue between 3rd -5th Streets

| | |
|--------------------|---|
| 5:00 am | Delivery of portable restrooms and setup of tents |
| 6:00 am - 11:00 am | Buses arrive. |
| 6:00 am – 2:00 pm | Portable Restrooms, First Aid and Hydration Stations open |
| 1:15 pm – 3:00 pm | Clean up and removal of equipment |
| 4:00 pm – 7:00 pm | Buses pickup on C Street |

Columbus Plaza

| | |
|-------------------|---------------------------------|
| 2:00 pm – 2:15 pm | March arrives in Columbus Plaza |
| 2:15 pm – 3:45 pm | Rally: chant, hold signs. |
| 3:45 pm – 4:00 pm | Participants begin to disperse. |

John Marshall Park -authorized equipment.

3 - 10x10ft Canopy Tents

VOLUNTEER TENT:

Table x3

Chairs x10

WATER TENT:

Table x3

Chairs x10

Water

FIRST AID TENT:

Table x3

Chairs x10

Pennsylvania Avenue sidewalks (north and south)

Table

Buttons

PERMIT: #24-1278

ISSUED TO: ANSWER COALITION

LOCATION: JOHN MARSHALL PARK, PENNSYLVANIA AVENUE NHS, NORTH AND SOUTH SIDEWALKS, AND COLUMBUS PLAZA

DATE: JULY 24, 2024 (5:00 AM –4:00 PM)

Columbus Plaza

Handheld signs

Portable sound system

March route

Exit Pennsylvania Avenue and 3rd Street

East on Constitution Avenue cross 3rd Street

Northeast onto Louisiana Avenue

East on Massachusetts Avenue

Enter Columbus Plaza

General Conditions

- A. This permit authorizes the use of the following park areas located within National Mall and Memorial Parks from 5:00 am on July 24 and concluding at 4:00 pm on July 24, 2024:
 - a. John Marshall Park
 - b. Pennsylvania Avenue NHS north and south sidewalks between 3rd – 5th Streets
 - c. Columbia Plaza (2:00 pm -4:00 pm)
- B. All structures must adhere to attached site plan; no additional structure (s) may be erected except in accordance with the site plan, permit and in coordination with permits office. Permittee indicated they are no longer setting up symbolic tents as part of the demonstration. Structures not listed in the permit will be removed and all permitted structures must be erected by the start of the demonstration rally start time. See equipment list above. **No site plan was provided by organizer as required by event guidelines.**
- C. ***NOTE: Due to the possibility of security measures, Presidential movements, and Head of State visits, permitted activity locations may be, temporarily moved and/or suspended.**
- D. The permittee is responsible for adhering to NCA Fire and Life Safety Temporary Event Policy and ensuring that all generators, tents, portable heaters and other applicable equipment adhere to requirements outlined with the document and this permit. The permittee assumes full responsibility for event elements safety and must ensure their contractors fully understand requirements outlined in the permit. In addition, the site must be ready for inspection by AHJ and/or designated representative prior to the event and upon request.
- E. The Permittee is responsible for obtaining the necessary permissions and/or additional permits from the Metropolitan Police Department (202) 671-6522, United States Capitol Police (202) 224-8891 or from other federal, state or local agencies or departments for the use of public lands other than those under the jurisdiction of the National Park Service.
- F. **Due to the exceptional time constraints associated with this permit and the complexity of multiple vendors bringing materials and equipment to park land, special attention is assigned to the requirement that the permittee must at all times provide an on-site coordinator at each permitted location to be accessible to National Park Service and United States Park Police personnel during the setup activities and during the load in/out of the event.**

PERMIT: #24-1278

ISSUED TO: ANSWER COALITION

LOCATION: JOHN MARSHALL PARK, PENNSYLVANIA AVENUE NHS, NORTH AND SOUTH SIDEWALKS, AND COLUMBUS PLAZA

DATE: JULY 24, 2024 (5:00 AM –4:00 PM)

- G. If Permittee or its agents/representatives/contractors/subcontractors cause any injury or damage to park system resources, they may be liable for costs and damages in accordance with the System Unit Resource Protection Act, 54 USC §§ 100721-100725.**
- H. Permittee will be responsible for any injury to, loss of, or damage to federally owned or controlled lands, waters, or resources (natural or cultural resources or facilities) resulting from Permittee's activities under this permit, 18 USC § 1361.**
- I. All request, correspondence and meetings with the National Park Service pertaining to this permit shall be scheduled by the permittee in writing only. All contractors, subcontractors or consultants must channel their request through the recognized representatives of the permittee who in turn will contact the National Park Service representative.
- J. The Permittee is responsible for providing all necessary equipment/objects to conduct this activity. All equipment must be removed from the park immediately following the conclusion of the event. Items left in the park will be considered abandoned property and will be removed by the National Park Service.
- K. Throughout the course of the permit, the Permittee will require employees/volunteers, and contractors, to exercise special care and attention to protect the resources of the permitted area and its environs. In addition, the Permittee must supervise their contractors, volunteers, and employees during setup and teardown to assure that there is no damage to park resources. The onsite contacts for ANSWER are:
 - 1. John Marshal Park:
 - 2. Columbus Plaza:
 - 3. Pennsylvania Avenue North Sidewalk b/w 3rd-5th Strs.:
 - 4. Pennsylvania Avenue South Sidewalk b/w 3rd-5th Strs.:

The contacts must be present physically present at each of the location for the entire duration demonstration permit times. (See above timelines)

- L. The permittee shall require all employees and/or contractors to exercise all normal and reasonable safety precautions and to protect park visitors and property. Suitable devices such as barricades, fences, lanterns, etc. necessary for employee and public safety, shall be provided and adequately maintained. Such devices require the concurrence of the NPS Coordinator or designated representative.
- M. **Marshals:** The ANSWER Coalition will provide at least 200 identifiable marshals to coordinate the various areas of the demonstration. All marshals involved with the organization will wear hi-res security vest and/or armbands. Pursuant to 36 CFR 7.96 (g)(5)(xii) organizers must undertake in good faith all reasonable action to provide sufficient marshals, to ensure good order and self-discipline in conducting such demonstration. Marshals should be aware of their responsibilities and location(s) where they will be stationed and have received from organizers adequate training and instructions. Marshals should be aware of the time and location of the assembly and any march routes, the location of any first aid stations, water, and toilets, be knowledgeable of the NPS permit conditions, be able to communicate with law enforcement. Marshals' area expected to report any problems they observe to Law Enforcement and/or National Park Service Permit Monitors. While marshals do not act as police, they do help maintain order among participants, explain to non-participants that a particular area may be under permit, and be able to alert their supervisor and the United States Park Police in the event they observe a problem on Federal parkland.

PERMIT: #24-1278

ISSUED TO: ANSWER COALITION

LOCATION: JOHN MARSHALL PARK, PENNSYLVANIA AVENUE NHS, NORTH AND SOUTH SIDEWALKS, AND COLUMBUS PLAZA

DATE: JULY 24, 2024 (5:00 AM –4:00 PM)

N. No interference with the pedestrian traffic and no blocking of entrances, sidewalks, or driveways is allowed. No impediment to or disruption of vehicular traffic is permitted. All areas are to remain open to the general public at all times.

O. Medical Aid: Person in charge is responsible for providing first aid services onsite. Permittee is required to adhere to recommendations provided by DC Fire and EMS. Permittee can rely on 911 for transport of patient. At a minimum permittee must have one Basic Life Support Medical Aid station and mobile med teams in all permitted locations. Please see attached plan for permittee medical plan.

1. John Marshall Park

Permittee per written first aid plan: Hydration Station(1) and First Aid Station (1) staffed by doctors, nurses and health care professionals from 10 am - ~1:00 pm.

P. Commercial Advertising Signage: Consistent with long-standing NPS regulations and policy, and Public Law 108-108, Title I, §145, the erection, placement, or use of structures and signs bearing commercial advertising is prohibited for any special event. The recognition of special events sponsors, however, may be allowed if it has been specifically authorized by this permit.

A permit may be issued that authorizes the recognition of sponsors of special events, if the NPS determines that the size and form of the recognition is consistent with the special nature and sanctity of the National Mall or any other requested park area, and if the lettering or design identifying the sponsor is no larger than one-third the size of the lettering or design identifying the special event. Further, to the maximum extent practicable for such special events, public use of and, access to the National Mall and other parkland is not to be restricted.

The Permittee shall submit a sign plan for NPS review and approval. Any request seeking NPS approval for sponsor recognition must be submitted to the NPS at least 14 days prior to the proposed event, and if approved by the NPS, will be authorized within the terms of the special event permit. Authorized sponsor recognition must be in keeping with NPS policy, regulations, and laws and be appropriate to the scale and theme of the special event. Further, the overall size, number, and design of any signs or banners shall be appropriate to the park setting and lettering or design identifying the special event. Signs and banners may not be affixed to existing trees or other NPS facilities or structures.

Only signs and/or banners specifically identifying and/or announcing the event or portion of the event are permitted. Commercial sponsors may be recognized on these same banners by letters and/or logos not to exceed one-third the height and width of the primary lettering identifying the event.

Q. Special attention is drawn to item #4, on the last page of this document, concerning solicitation and sales. No fee may be collected, donation solicited, or commercial activity conducted. No items may be sold or offered for sale except for books, newspapers, leaflets, pamphlets, buttons and bumper stickers which contain a message related to your demonstration or special event. Permittee will have onsite sales at John Marshall Park, Pennsylvania Avenue Sidewalks north and south between 3rd-4th Streets, the stand or structure may consist of one table per site, which may be no larger than 2 ½ ft by 8ft or 4ft by 4ft. The dimensions of the sales site may not exceed 6ft (w) by 15ft long by 6ft high. No other items maybe sold other than those listed.

Sales table is located in the John Marshall Park and Pennsylvania Avenue Sidewalks between 3rd – 5th Streets, permittee has not provided a detailed site plan. Permittee has indicated the sales of buttons.

PERMIT: #24-1278

ISSUED TO: ANSWER COALITION

LOCATION: JOHN MARSHALL PARK, PENNSYLVANIA AVENUE NHS, NORTH AND SOUTH
SIDEWALKS, AND COLUMBUS PLAZA

DATE: JULY 24, 2024 (5:00 AM –4:00 PM)

- R. **All sound amplification equipment shall be limited so that it will not unreasonably disturb nonparticipating persons in, or in the vicinity of, the area. National Park Service has issued a Record of Determination in John Marshall Park during regular business hours, therefore no amplified sound is allowed in John Marshall Park as part of this activity.**
- S. **Balloons of any kind, glass containers and alcoholic beverages are not permitted.**
- T. **The collection of entry/registration fee is prohibited on parkland.**
- U. Permittee's desiring the use of temporary structures, i.e. cable trusses, stages, audio and/or video towers and tents, whose dimensions are (500) square feet or more, shall provide Life Safety Code certification statements confirming the safety of all temporary structures. In the event that the manufacture's certifications are not available, permittee will submit to the NPS stamped engineered drawings for NPS review and approval. **Smaller structures cannot be attached or within 5ft of another to create a larger structure.**
- V. All activities pursuant to this permit shall be in compliance with the requirements of Title VI of the Civil Rights Act of 1964 (78 Stat. 252; 42 U.S.C. 200d ed seg.); Title V, Section 504 of the Rehabilitation Act of 1973 (87 Stat. 394; 29 U.S.C 794); the Age Discrimination Act of 1975 (89 Stat. 728; 42 U.S.C. 6101 et seg.); and with all other Federal laws and regulations prohibiting discrimination of grounds of race, color, national origin, handicap, religion, or sex in employment and in providing facilities and services to the public. Nothing advertising for employees shall be done which will prevent those covered by these laws from qualifying for employment.
- W. **Portable Restrooms:** If attendance is expected to exceed the capacity of nearby NPS public comfort facilities, or if none exist in or near the requested park area, the Permittee must provide portable, temporary toilets with sufficient capacity to accommodate anticipated attendance. The general guideline is a minimum of (1) portable toilet per (300) people, of which at least twenty percent (%20) must be handicapped accessible. The restrooms should be grouped in banks of five with a six-foot clearance between each bank.
1. John Marshall Park– 10 Portable Restrooms –The portable restrooms must be hand carted and retrieved for the area.
 2. Portable restroom trucks may not drive on sidewalk and should furnish a hose long enough to clean portable restrooms
 3. Portable restrooms must be delivered and removed the same day of the demonstration.
- X. **Tents:** Permittee's authorized use of temporary structures, i.e. cable trusses, stages, audio and/or video towers and tents, whose dimensions are (900) square feet or more, **shall provide Life Safety Code certification statements confirming the safety of all temporary structures. In the event that the manufacture's certifications are not available, permittee will submit to the NPS stamped engineered drawings for NPS review and approval. Smaller structures cannot be attached or within 5ft of another to create a larger structure.**
- a. **A minimum 10ft. clearance must be maintained from tents to any flammable or combustible materials or vegetation.**

PERMIT: #24-1278

ISSUED TO: ANSWER COALITION

LOCATION: JOHN MARSHALL PARK, PENNSYLVANIA AVENUE NHS, NORTH AND SOUTH SIDEWALKS, AND COLUMBUS PLAZA

DATE: JULY 24, 2024 (5:00 AM –4:00 PM)

- b. Aisle Width:** The width of aisles serving seating at tables shall be not less than 44 in. where serving occupant load exceeding 50 people, and 36 in. where serving an occupant load of 49 people or fewer. In addition all tent exits must have a minimum head clearance height of 7ft.
- c. Exit and Occupant Loads for Enclosed Tents:** Tents that have sides attached and those with rolled up sides which are capable of being enclosed shall meet the following occupancy load and exit requirements.

| Y. Occupant Load | Z. Floor Area | AA. Approx. Tent Sizes | BB. Min. Exits |
|--------------------|-------------------------|-----------------------------------|----------------|
| CC. <49 people | DD. <343 Sq. Ft. | EE. 10'x10', 10'x30', 15'x15' | FF. 1 |
| GG. 50-499 people | HH. 350-3,493 Sq. Ft. | II. 15'x 30', 40' x 40', 40' x80' | JJ. 2 |
| KK. 500-999 people | LL. 3,500-6,993 Sq. Ft. | MM. 40' x 100', 60' x 100' | NN. 3 |
| OO. >1000 people | PP. >7,000 Sq. Ft. | QQ. 80' x 100', 60'x 160' | RR. 4 or more |

SS. Tents must be supported by water barrels or cement blocks. STAKING IS NOT PERMITTED. In order to prevent damage to brick, stonework, or other surfaces, protective material such as plywood, carpet squares or rubber pads must be in place under all equipment, including speaker stands, lighting stands, generators, tables and tents.

TT. GENERATORS: No generators have been requested at the permitted areas, therefore generators are prohibited.

UU. Contact Park Ranger (b) (6), (b) (7)(C), National Park Service, at (b) (6), (b) (7)(C) with questions or to discuss additional information regarding logistical setup.

VV. Contact Lt. Timothy Van Dyke , United States Park Police, 202-426-6710 , with questions concerning police procedures or logistics.

WW. NPS and USPP onsite representatives

- a. (b) (6), (b) (7)(C)
- b. (b) (6), (b) (7)(C)
- c. Tim Van Dyke (b) (6), (b) (7)(C)

XX. In case of an emergency, please contact USPP dispatch at (202) 610-7500.

A complete and legible copy of this permit must be retained on-site by the Permittee at all times while operating under the authority granted.

PERMIT: #24-1278

ISSUED TO: ANSWER COALITION

**LOCATION: JOHN MARSHALL PARK, PENNSYLVANIA AVENUE NHS, NORTH AND SOUTH
SIDEWALKS, AND COLUMBUS PLAZA**

DATE: JULY 24, 2024 (5:00 AM –4:00 PM)

General Resource Protection:

YY. Pursuant to 36 CFR 7.96(g)(xii), the alteration, damage, or removal of park resources or facilities is prohibited. No holes may be dug and no item, including signs or banners, may be attached to park trees, plantings, benches, fences, light standards, or any other park landscape element.

ZZ. It is prohibited to climb, remove, or in any way injure any statue seat, wall, fountain, light poles, elevator towers, or other erection or architectural feature, or any tree, shrub, or landscaping feature within the park. Permittee is responsible for informing event participants and providing marshals to ensure compliance with this permit condition.

AAA. **Public Access:** Sidewalks and entrances seven feet wide or larger, a six foot minimum clearance must be maintained at all times to allow for two wheelchairs to pass each other. And for sidewalks and entrances of (5-6) feet wide, a four-foot minimum width must be maintained at all times for wheel chair accessibility.

BBB. **In order to prevent damage to brick, stonework, or other surfaces, protective material such as plywood or rubber pads must be in place under all equipment, including speaker stands, lighting stands, generators, tables and tents.**

CCC. Helium inflated items and drones are not permitted on Parkland.

DDD. **Trash/debris pickup:** Permittee indicated to be responsible for all trash and debris from the permitted areas immediately after the conclusion of the demonstration. Trash receptacles for this effort shall be provided and removed from the site accordingly by the permit holder. Trash receptacles must not overflow with trash or debris. Use of clear trash bags is required for all trash receptacles used for the event.

EEE. **Fire Hydrants:** A minimum 36 in. of clear space shall be maintained to permit access to and operation of fire protection equipment, fire department inlet connections, or fire protection system control valves. Vehicles must maintain a 15 ft. clearance of all fire hydrants.

FFF. **Outdoor Equipment. (A) Wet Locations.** All switches, circuit breakers, receptacles, control equipment, and metering devices located in wet locations shall be weatherproof.
(NFPA70:551.78 (2017))

GGG. **OPEN-FLAME DEVICES.** Open-flame decorative devices, **candles, oil lamps, decorative torches and gas lights** are **NOT authorized** in any tent or temporary structures.

HHH. **COMBUSTIBLE OR FLAMMABLE LIQUIDS shall NOT be stored on NPS property.**
NCA-AHJ

III. **Weather (adverse) Policy during an Event Program:** When there is a threat to public health or safety, the Superintendent and/or designee, may close the National Mall or an event being hold there for such duration as determined necessary to ensure the safety and well being of the public. Such situations have occasionally occurred in the past where park areas have been closed due to severe weather warning of heavy snow, thunderstorms with lightning, high winds, cold and intense heat. Where an area is ordered closed due to a weather-related public safety threat, pursuant to 36 CFR